



THE RESERVE
RESIDENCES



HORIZON

FLOOR PLANS

THE HEART OF BUKIT TIMAH



Welcome to the heart of Bukit Timah, a prestigious and sought-after location that embodies the best of urban living. This prime estate is known for its upscale residences, top-tier schools, and abundance of greenery, offering an unparalleled lifestyle that combines the convenience of modern amenities with the serenity of lush greenery.

SCHEMATIC DIAGRAM

LEGEND	
*	Mirror Layout
▲	Acoustic Ceiling
#	Balcony Screen
■	Acoustic Façade Treatment with Fins and/or Ledges
All units will be fitted with window restrictor.	







THE RESERVE RESIDENCES

-  1-Bedroom Type A1, A2
-  2-Bedroom Type B1-B7A
-  2-Bedroom + Study Type B8-B9A
-  3-Bedroom Type C1-C4
-  3-Bedroom + Study Type C5

HORIZON

-  3-Bedroom Type C9-C10P
-  4-Bedroom Type D2-D4

TREETOPS

-  4-Bedroom + Study Type G1
-  4-Bedroom + Study (Sky Terrace) Type D5
-  4-Bedroom + Study (Duplex) Type G2
-  5-Bedroom Type G3, G4
-  5-Bedroom (Sky Terrace) Type E1-E3
-  5-Bedroom (Duplex) Type G5
-  5-Bedroom (Penthouse) Type P1-P4

9 JALAN ANAK BUKIT

11 JALAN ANAK BUKIT

UNIT / FLOOR	80	81	82	83	84	85	86	87	88	89	90	91	92	93	94	95	96	97	98	99	UNIT / FLOOR	
17	SKY TERRACE											SKY TERRACE								17		
16	A1	A1*	C4▲	C4*▲	A1	A2	A2*	B3*	C9	B7	A1*	A1	C2	C10	B3	A2	A2*	C3	D2▲	B1	16	
15	A1	A1*	C4▲	C4*▲	A1	A2	A2*	B3*	C9	B7	A1*	A1	C2	C10	B3	A2	A2*	C3	D2▲	B1	15	
14	A1	A1*	C4▲	C4*▲	A1	A2	A2*	B3*	C9	B7	A1*	A1	C2	C10	B3	A2	A2*	C3	D2▲	B1	14	
13	A1	A1*	C4▲	C4*▲	A1	A2	A2*	B3*	C9	B7	A1*	A1	C2	C10	B3	A2	A2*	C3	D2▲	B1	13	
12	A1	A1*	C4▲	C4*▲	A1	A2	A2*	B3*	C9	B7	A1*	A1	C2	C10	B3	A2	A2*	C3	D2▲	B1	12	
11	A1	A1*	C4▲	C4*▲	A1	A2	A2*	B3*	C9	B7	A1*	A1	C2	C10	B3	A2	A2*	C3	D2▲	B1	11	
10	A1	A1*	C4▲	C4*▲	A1	A2	A2*	B3*	C9	B7	A1*	A1	C2	C10	B3	A2	A2*	C3	D2▲	B1	10	
9	A1	A1*	C4▲	C4*▲	A1	A2	A2*	B3*	C9	B7	A1*	A1	C2	C10	B3	A2	A2*	C3	D2▲	B1	9	
8	A1	A1*	C4▲	C4*▲	A1	A2	A2*	B3*	C9	B7	A1*	A1	C2	C10	B3	A2	A2*	C3	D2▲	B1	8	
7	A1	A1*	C4▲	C4*▲	A1	A2	A2*	B3*	C9	B7	A1*	A1	C2	C10	B3	A2	A2*	C3	D2▲	B1	7	
6	A1	A1*	C4▲	C4*▲	A1	A2	A2*	B3*	C9	B7	A1*	A1	C2	C10	B3	A2	A2*	C3	D2▲	B1	6	
5	LANDSCAPE		C4P▲	C4*▲	A1	LANDSCAPE		B3*	C9	LANDSCAPE		LANDSCAPE		C10	B3	LANDSCAPE		G2	D2P▲	LANDSCAPE		5
4	LANDSCAPE / RESIDENTIAL CARPARK			G1▲		LANDSCAPE / RESIDENTIAL CARPARK		G3		LANDSCAPE / RESIDENTIAL CARPARK		LANDSCAPE / RESIDENTIAL CARPARK		G4		LANDSCAPE / RESIDENTIAL CARPARK		G2		LANDSCAPE / RESIDENTIAL CARPARK		4
3	RETAIL											BUS INTERCHANGE								3		
2	RETAIL											BUS INTERCHANGE								2		
1	RETAIL											RETAIL								1		
B1	RETAIL											RETAIL								B1		
B1M	RETAIL											RETAIL								B1M		

Continued on next page

UNIT / FLOOR	100	101	102	103	104	105	106	107	108	109	110	111	112	113	114	115	116	117	UNIT / FLOOR			
33	ROOF TERRACE									ROOF TERRACE									33			
32	P4			WATER TANK			P1▲#■			P2▲#■			WATER TANK			P3*▲#■			P3▲#■			32
31	B5A*▲#■	B9A▲#■	D2	B4A	B8*		C10▲#■	B6▲#■	B5A▲#■	C5▲#■	C9▲#■		B8	B5A*	D4*▲#■	D4▲#■	C1▲#■		31			
30	B5A*▲#■	B9A▲#■	D2	B4A	B8*	C2A	C10▲#■	B6▲#■	B5A▲#■	C5▲#■	C9▲#■	B7A	B8	B5A*	D4*▲#■	D4▲#■	C1▲#■		30			
29	B5A*▲#■	B9A▲#■	D2	B4A	B8*	C2A	C10▲#■	B6▲#■	B5A▲#■	C5▲#■	C9▲#■	B7A	B8	B5A*	D4*▲#■	D4▲#■	C1▲#■		29			
28	B5A*▲#■	B9A▲#■	D2	B4A	B8*	C2A	C10▲#■	B6▲#■	B5A▲#■	C5▲#■	C9▲#■	B7A	B8	B5A*	D4*▲#■	D4▲#■	C1▲#■		28			
27	B5A*▲#■	B9A▲#■	D2	B4A	B8*	C2A	C10▲#■	B6▲#■	B5A▲#■	C5▲#■	C9▲#■	B7A	B8	B5A*	D4*▲#■	D4▲#■	C1▲#■		27			
26	B5A*▲#■	B9A▲#■	D2	B4A	B8*	C2A	C10▲#■	B6▲#■	B5A▲#■	C5▲#■	C9▲#■	B7A	B8	B5A*	D4*▲#■	D4▲#■	C1▲#■		26			
25	B5A*▲#■	B9A▲#■	D2	B4A	B8*	C2A	C10▲#■	B6▲#■	B5A▲#■	C5▲#■	C9▲#■	B7A	B8	B5A*	D4*▲#■	D4▲#■	C1▲#■		25			
24	B5A*▲#■	B9A▲#■	D2	B4A	B8*	C2A	C10▲#■	B6▲#■	B5A▲#■	C5▲#■	C9▲#■	B7A	B8	B5A*	D4*▲#■	D4▲#■	C1▲#■		24			
23	B5A*▲#■	B9A▲#■	D2	B4A	B8*	C2A	C10▲#■	B6▲#■	B5A▲#■	C5▲#■	C9▲#■	B7A	B8	B5A*	D4*▲#■	D4▲#■	C1▲#■		23			
22	B5A*▲#■	B9A▲#■	D2	B4A	B8*	C2A	C10▲#■	B6▲#■	B5A▲#■	C5▲#■	C9▲#■	B7A	B8	B5A*	D4*▲#■	D4▲#■	C1▲#■		22			
21	B5A*▲#■	B9A▲#■	D2	B4A	B8*	C2A	C10▲#■	B6▲#■	B5A▲#■	C5▲#■	C9▲#■	B7A	B8	B5A*	D4*▲#■	D4▲#■	C1▲#■		21			
20	B5A*▲#■	B9A▲#■	D2	B4A	B8*	C2A	C10▲#■	B6▲#■	B5A▲#■	C5▲#■	C9▲#■	B7A	B8	B5A*	D4*▲#■	D4▲#■	C1▲#■		20			
19	B5A*▲#■	B9A▲#■	D2	B4A	B8*	C2A	C10▲#■	B6▲#■	B5A▲#■	C5▲#■	C9▲#■	B7A	B8	B5A*	D4*▲#■	D4▲#■	C1▲#■		19			
18	B5A*▲#■	B9A▲#■	D2	B4A	B8*	C2A	C10▲#■	B6▲#■	B5A▲#■	C5▲#■	C9▲#■	B7A	B8	B5A*	D4*▲#■	D4▲#■	C1▲#■		18			
17	SKY TERRACE		D5	SKY TERRACE			E3▲#■		SKY TERRACE	SKY TERRACE	E2▲#■		SKY TERRACE			E1*▲#■	E1▲#■	SKY TERRACE	17			
16	B2*■	B9■	D2	B4	B5*	C2	C10▲#■	B3■	B2■	B2*▲#■	B3*▲#■	C9▲#■	B7	B5	B5*	D4*▲#■	D4▲#■	B2▲#■	16			
15	B2*■	B9■	D2	B4	B5*	C2	C10▲#■	B3■	B2■	B2*▲#■	B3*▲#■	C9▲#■	B7	B5	B5*	D4*▲#■	D4▲#■	B2▲#■	15			
14	B2*■	B9■	D2	B4	B5*	C2	C10▲#■	B3■	B2■	B2*▲#■	B3*▲#■	C9▲#■	B7	B5	B5*	D4*▲#■	D4▲#■	B2▲#■	14			
13	B2*■	B9■	D2	B4	B5*	C2	C10▲#■	B3■	B2■	B2*▲#■	B3*▲#■	C9▲#■	B7	B5	B5*	D4*▲#■	D4▲#■	B2▲#■	13			
12	B2*■	B9■	D2	B4	B5*	C2	C10▲#■	B3■	B2■	B2*▲#■	B3*▲#■	C9▲#■	B7	B5	B5*	D4*▲#■	D4▲#■	B2▲#■	12			
11	B2*■	B9■	D2	B4	B5*	C2	C10▲#■	B3■	B2■	B2*▲#■	B3*▲#■	C9▲#■	B7	B5	B5*	D4*▲#■	D4▲#■	B2▲#■	11			
10	B2*■	B9■	D2	B4	B5*	C2	C10▲#■	B3■	B2■	B2*▲#■	B3*▲#■	C9▲#■	B7	B5	B5*	D4*▲#■	D4▲#■	B2▲#■	10			
9	B2*■	B9■	D2	B4	B5*	C2	C10▲#■	B3■	B2■	B2*▲#■	B3*▲#■	C9▲#■	B7	B5	B5*	D4*▲#■	D4▲#■	B2▲#■	9			
8	B2*■	B9■	D2	B4	B5*	C2	C10▲#■	B3■	B2■	B2*▲#■	B3*▲#■	C9▲#■	B7	B5	B5*	D4*▲#■	D4▲#■	B2▲#■	8			
7	B2*■	B9■	D2	B4	B5*	C2	C10▲#■	B3■	B2■	B2*▲#■	B3*▲#■	C9▲#■	B7	B5	B5*	D4*▲#■	D4▲#■	B2▲#■	7			
6	B2*■	B9■	D2	B4	B5*	C2	C10▲#■	B3■	B2■	B2*▲#■	B3*▲#■	C9▲#■	B7	B5	B5*	D4*▲#■	D4▲#■	B2▲#■	6			
5	LANDSCAPE	B9P■	G5	LANDSCAPE			C10P▲#■	LANDSCAPE			LANDSCAPE			C9P▲#■	LANDSCAPE			D3*▲#■	D3▲#■	LANDSCAPE	5	
4	LANDSCAPE / RESIDENTIAL CARPARK			LANDSCAPE / RESIDENTIAL CARPARK									LANDSCAPE / RESIDENTIAL CARPARK			D3P*▲#■	D3P▲#■	LANDSCAPE / RESIDENTIAL CARPARK	4			
3	RETAIL											RESIDENTIAL DROP-OFF							3			
2	RETAIL																			2		
1	RETAIL & SERVICED RESIDENCES CARPARK																			1		
B1																				B1		
B1M																				B1M		

Continued from previous page

LEGEND	
*	Mirror Layout
▲	Acoustic Ceiling
#	Balcony Screen
■	Acoustic Façade Treatment with Fins and/or Ledges
All units will be fitted with window restrictor.	

UNIT PLAN LEVEL 4





- Others**
- A Residential Entrance (Level 3)
 - B Water Tanks (Level 12, 17, 31, 32)
 - C Generator Set (Level 6)
 - D Substation (Level 1)
 - E Bin Centre (Level 1)
 - F Cooling Towers (Level 4)

HORIZON

 4-Bedroom
Type D3P

TREETOPS

 4-Bedroom + Study
Type G1

 4-Bedroom + Study (Duplex)
Type G2

 5-Bedroom
Type G3, G4

 5-Bedroom (Duplex)
Type G5

UNIT PLAN LEVEL 5



THE RESERVE RESIDENCES

-  1-Bedroom Type A1
-  2-Bedroom + Study Type B9P
-  2-Bedroom Type B3
-  3-Bedroom Type C4, C4P

HORIZON

-  3-Bedroom Type C9-C10P
-  4-Bedroom Type D2P, D3

TREETOPS

-  4-Bedroom + Study (Duplex) Type G2
-  5-Bedroom (Duplex) Type G5

UNIT PLAN LEVEL 6-16





- Others**
- A Residential Entrance (Level 3)
 - B Water Tanks (Level 12, 17, 31, 32)
 - C Generator Set (Level 6)
 - D Substation (Level 1)
 - E Bin Centre (Level 1)
 - F Cooling Towers (Level 4)

THE RESERVE RESIDENCES

-  1-Bedroom Type A1, A2
-  2-Bedroom Type B1-B5, B7
-  2-Bedroom + Study Type B9
-  3-Bedroom Type C2, C3, C4

HORIZON

-  3-Bedroom Type C9, C10
-  4-Bedroom Type D2, D4

CREEKSIDE

-  3-Bedroom Type C6-C8P
-  4-Bedroom Type D1, D1P

UNIT PLAN LEVEL 18-30



THE RESERVE RESIDENCES

 2-Bedroom
Type B4A-B7A

 2-Bedroom + Study
Type B8, B9A

 3-Bedroom
Type C1, C2A

 3-Bedroom + Study
Type C5

HORIZON



 3-Bedroom
Type C9, C10

 4-Bedroom
Type D2, D4

UNIT PLAN LEVEL 31



THE RESERVE RESIDENCES

-  2-Bedroom
Type B4A, B5A, B6
-  2-Bedroom + Study
Type B8, B9A

-  3-Bedroom
Type C1
-  3-Bedroom + Study
Type C5

HORIZON

-  3-Bedroom
Type C9, C10
-  4-Bedroom
Type D2, D4

1 - BEDROOM . TYPE A1

41 sqm | 441 sqft

9 Jalan Anak Bukit: #06-80 to #16-80, #05-84 to #16-84
 #06-81 to #16-81, #06-90 to #16-90 (Mirrored)
 11 Jalan Anak Bukit: #06-91 to #16-91

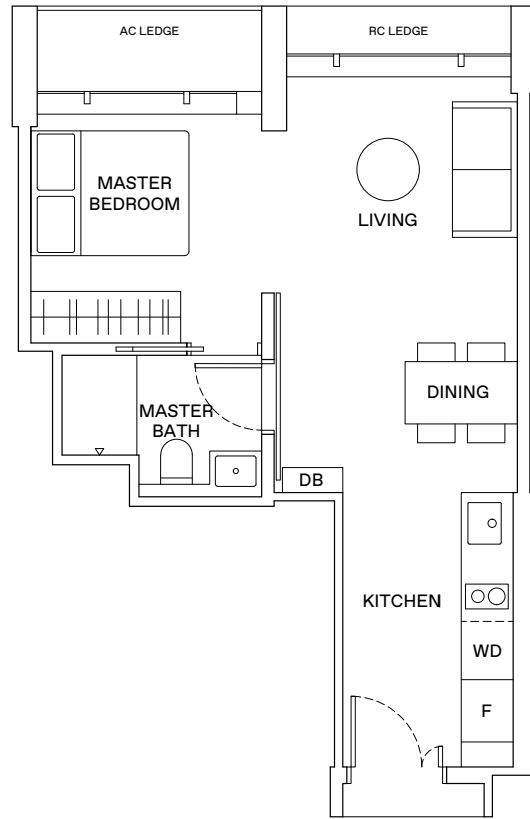

1 - BEDROOM . TYPE A2

46 sqm | 495 sqft

9 Jalan Anak Bukit: #06-85 to #16-85
 #06-86 to #16-86 (Mirrored)
 11 Jalan Anak Bukit: #06-95 to #16-95
 #06-96 to #16-96 (Mirrored)

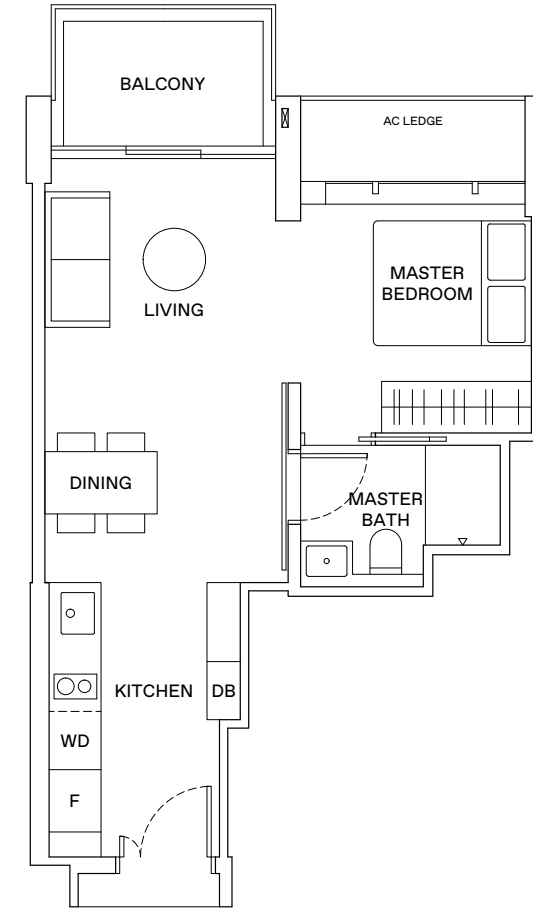

LEGEND

- WD WASHER-DRYER
- W/D WASHER AND DRYER
- F FRIDGE
- DB DISTRIBUTION BOX



AREA INCLUDES AIR-CON (A/C) LEDGE, BALCONY AND STRATA VOID AREA WHERE APPLICABLE. THE PLANS ARE SUBJECT TO CHANGE AS MAY BE APPROVED BY RELEVANT AUTHORITIES. ALL FLOOR PLANS ARE APPROXIMATE MEASUREMENTS ONLY AND ARE SUBJECT TO GOVERNMENT RE-SURVEY. THE BALCONY SHALL NOT BE ENCLOSED UNLESS WITH THE APPROVED BALCONY SCREEN. FOR AN ILLUSTRATION OF THE APPROVED BALCONY SCREEN, PLEASE REFER TO THE DIAGRAM ANNEXED HERETO AS "ANNEXURE A".

KEY PLAN
 THIS KEY PLAN IS NOT TO SCALE

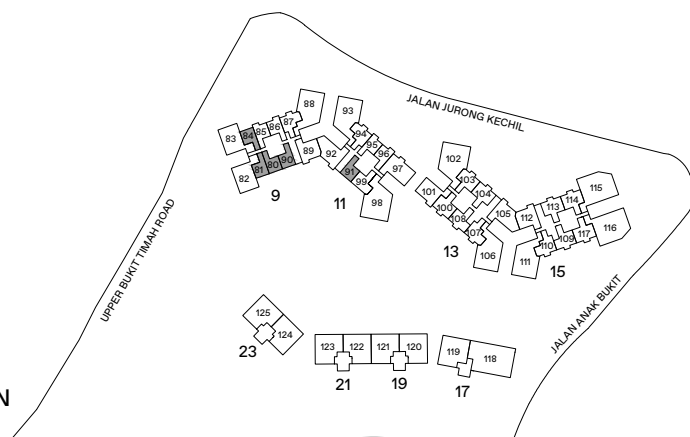

LEGEND

- WD WASHER-DRYER
- W/D WASHER AND DRYER
- F FRIDGE
- DB DISTRIBUTION BOX



AREA INCLUDES AIR-CON (A/C) LEDGE, BALCONY AND STRATA VOID AREA WHERE APPLICABLE. THE PLANS ARE SUBJECT TO CHANGE AS MAY BE APPROVED BY RELEVANT AUTHORITIES. ALL FLOOR PLANS ARE APPROXIMATE MEASUREMENTS ONLY AND ARE SUBJECT TO GOVERNMENT RE-SURVEY. THE BALCONY SHALL NOT BE ENCLOSED UNLESS WITH THE APPROVED BALCONY SCREEN. FOR AN ILLUSTRATION OF THE APPROVED BALCONY SCREEN, PLEASE REFER TO THE DIAGRAM ANNEXED HERETO AS "ANNEXURE A".

KEY PLAN
 THIS KEY PLAN IS NOT TO SCALE

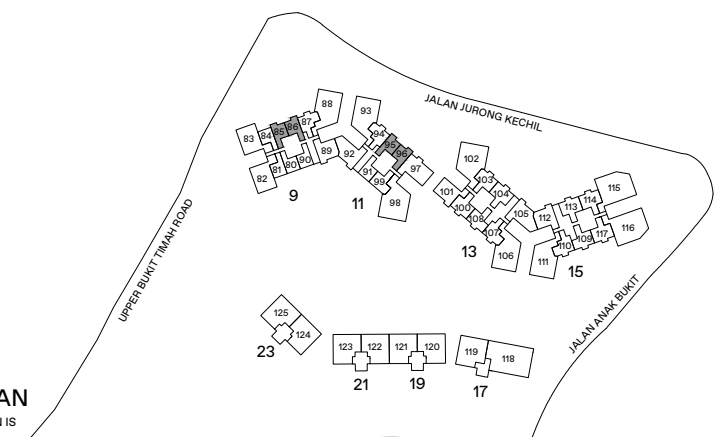

2 - BEDROOM . TYPE B1

52 sqm | 560 sqft

11 Jalan Anak Bukit: #06-99 to #16-99

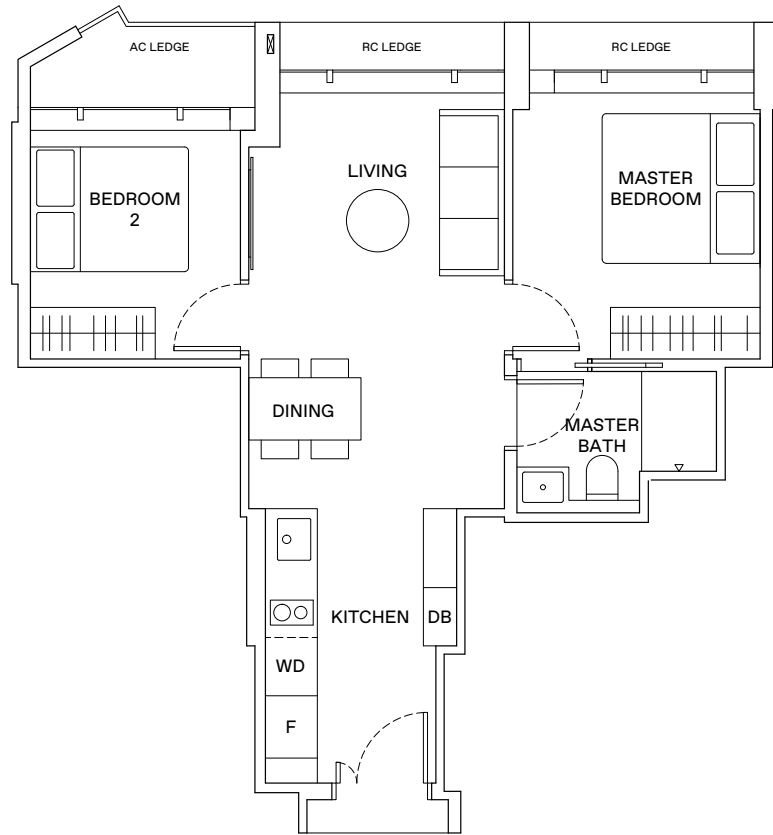

LEGEND

WD WASHER-DRYER
 W/D WASHER AND DRYER
 F FRIDGE
 DB DISTRIBUTION BOX

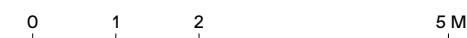

AREA INCLUDES AIR-CON (A/C) LEDGE, BALCONY AND STRATA VOID AREA WHERE APPLICABLE. THE PLANS ARE SUBJECT TO CHANGE AS MAY BE APPROVED BY RELEVANT AUTHORITIES. ALL FLOOR PLANS ARE APPROXIMATE MEASUREMENTS ONLY AND ARE SUBJECT TO GOVERNMENT RE-SURVEY. THE BALCONY SHALL NOT BE ENCLOSED UNLESS WITH THE APPROVED BALCONY SCREEN. FOR AN ILLUSTRATION OF THE APPROVED BALCONY SCREEN, PLEASE REFER TO THE DIAGRAM ANNEXED HERETO AS 'ANNEXURE A'.

KEY PLAN
 THIS KEY PLAN IS NOT TO SCALE

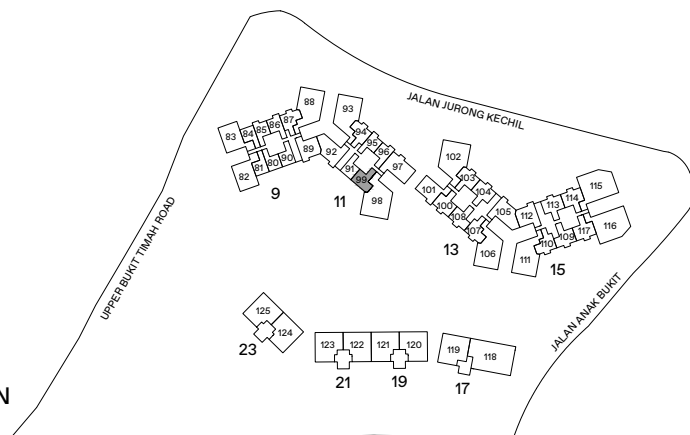

2 - BEDROOM . TYPE B2

57 sqm | 614 sqft

13 Jalan Anak Bukit: #06-100 to #16-100 (Mirrored)

#06-108 to #16-108

15 Jalan Anak Bukit: #06-109 to #16-109 (Mirrored)

#06-117 to #16-117

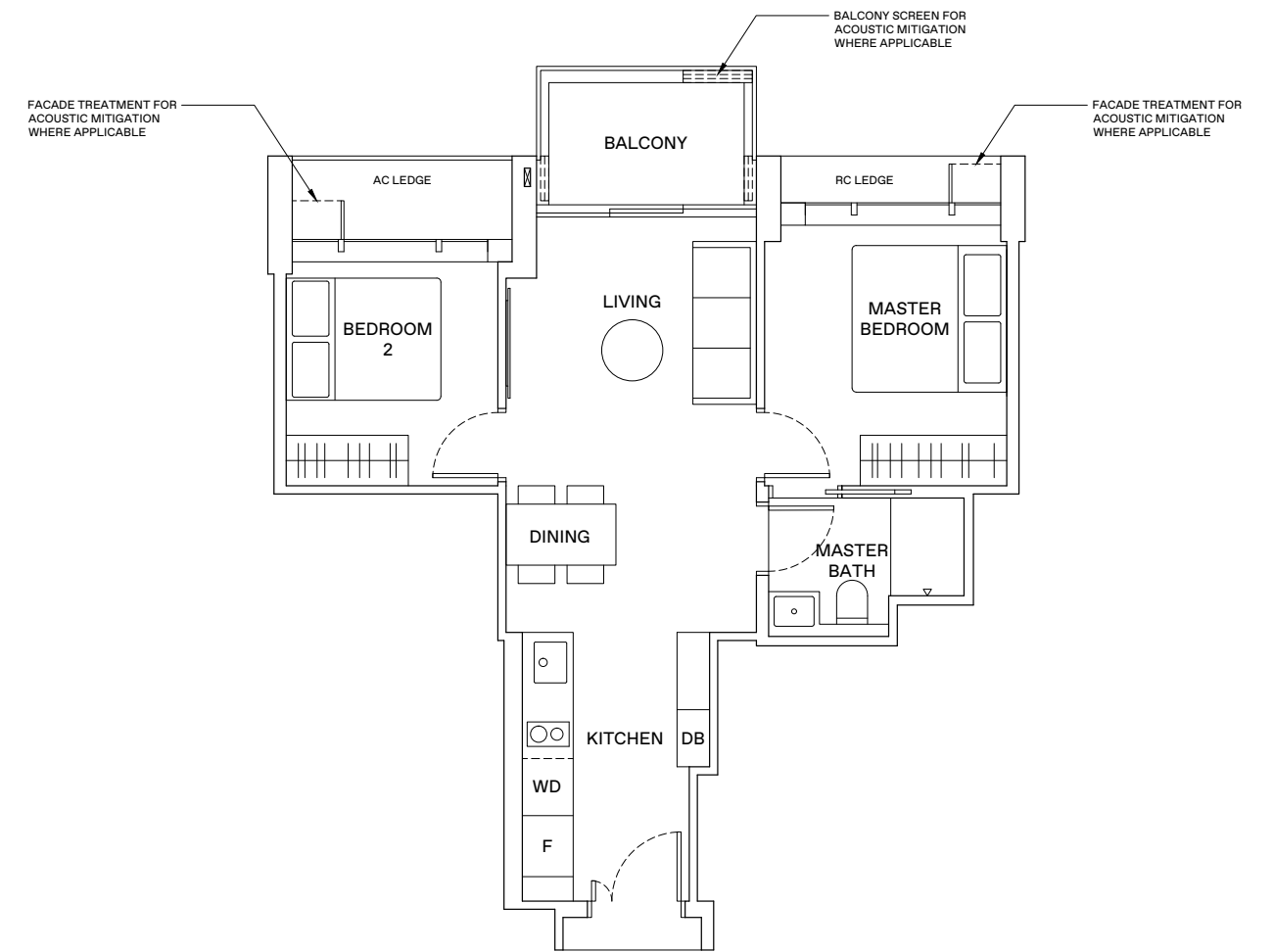

LEGEND

WD WASHER-DRYER
 W/D WASHER AND DRYER
 F FRIDGE
 DB DISTRIBUTION BOX



AREA INCLUDES AIR-CON (A/C) LEDGE, BALCONY AND STRATA VOID AREA WHERE APPLICABLE. THE PLANS ARE SUBJECT TO CHANGE AS MAY BE APPROVED BY RELEVANT AUTHORITIES. ALL FLOOR PLANS ARE APPROXIMATE MEASUREMENTS ONLY AND ARE SUBJECT TO GOVERNMENT RE-SURVEY. THE BALCONY SHALL NOT BE ENCLOSED UNLESS WITH THE APPROVED BALCONY SCREEN. FOR AN ILLUSTRATION OF THE APPROVED BALCONY SCREEN, PLEASE REFER TO THE DIAGRAM ANNEXED HERETO AS 'ANNEXURE A'.

KEY PLAN
 THIS KEY PLAN IS NOT TO SCALE

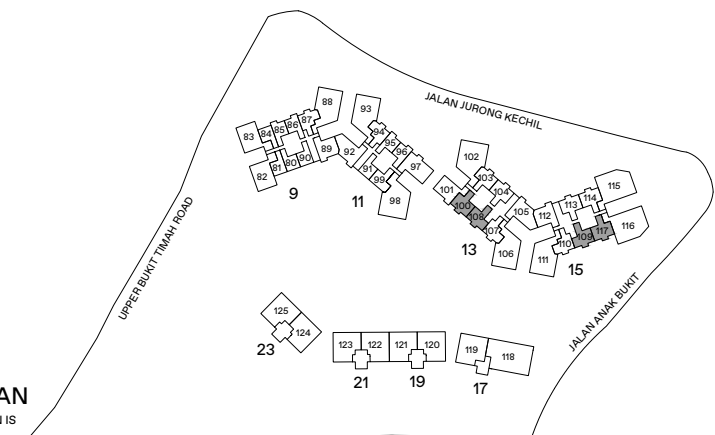

2 - BEDROOM . TYPE B3

57 sqm | 614 sqft

9 Jalan Anak Bukit: #05-87 to #16-87 (Mirrored)
 11 Jalan Anak Bukit: #05-94 to #16-94
 13 Jalan Anak Bukit: #06-107 to #16-107
 15 Jalan Anak Bukit: #06-110 to #16-110 (Mirrored)

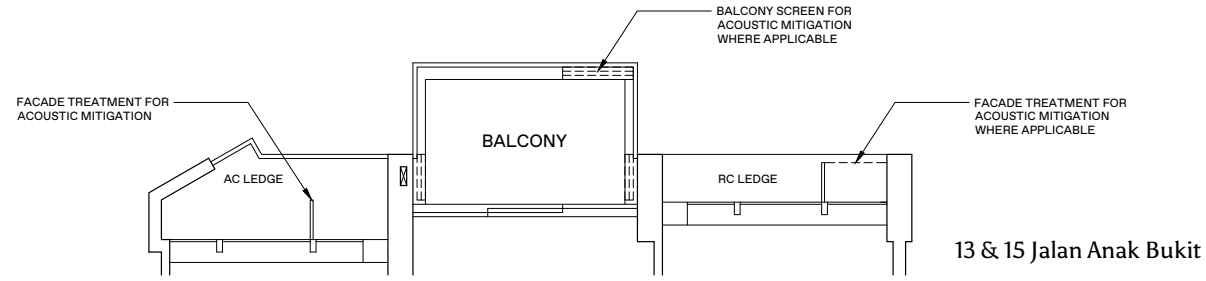

13 & 15 Jalan Anak Bukit

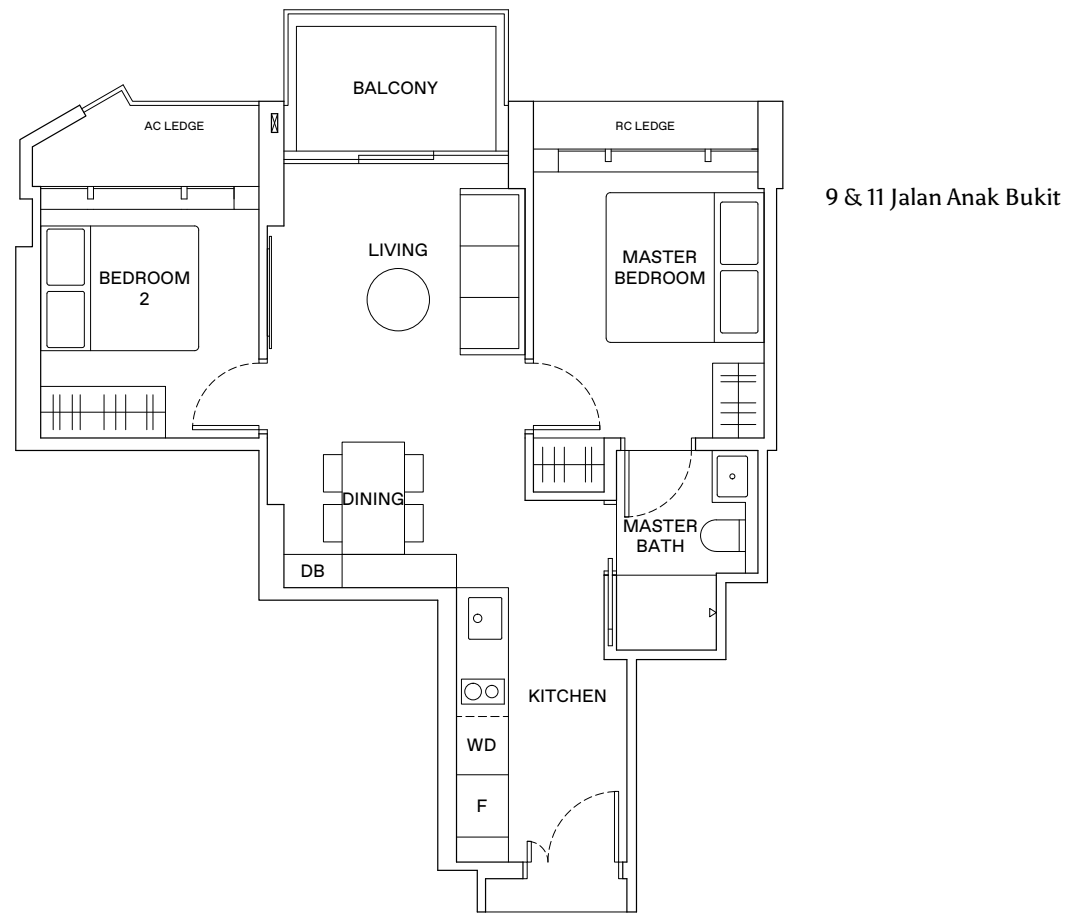

9 & 11 Jalan Anak Bukit

2 - BEDROOM . TYPE B4/B4A

60 sqm | 646 sqft (B4), 61 sqm | 657 sqft (B4A)

13 Jalan Anak Bukit: #06-103 to #16-103 (B4)
 #18-103 to #31-103 (B4A)

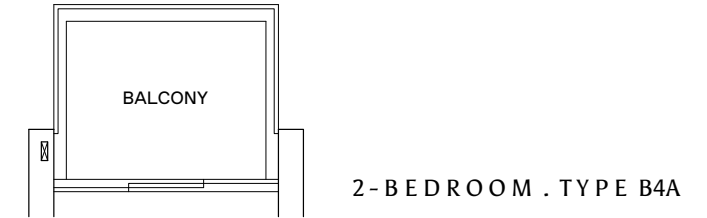

2-BEDROOM . TYPE B4A

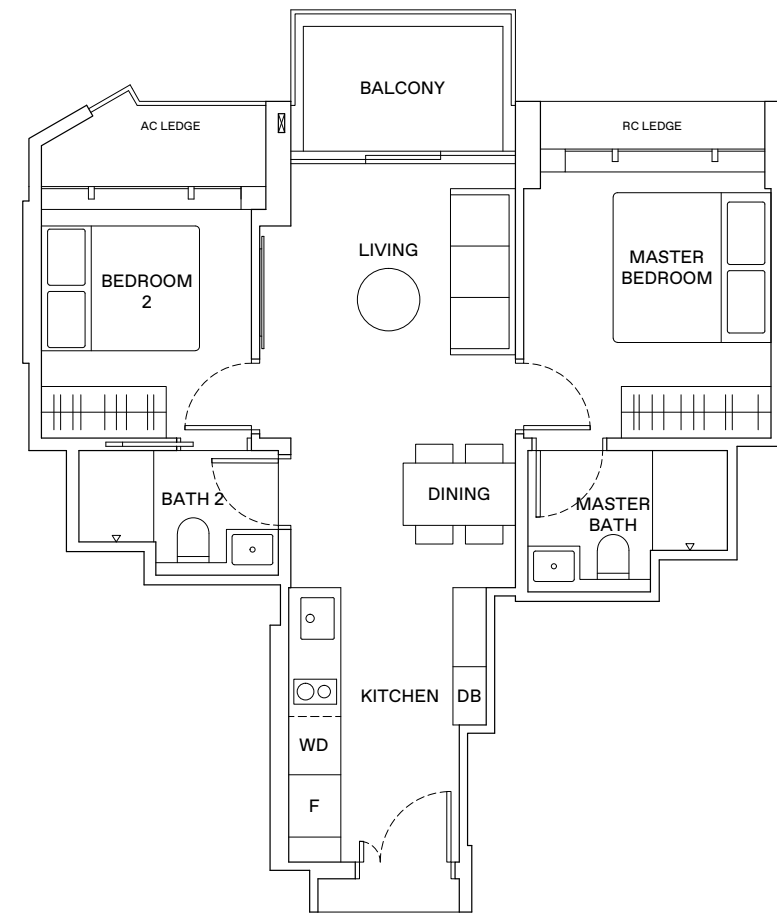

LEGEND

WD WASHER-DRYER
 W/D WASHER AND DRYER
 F FRIDGE
 DB DISTRIBUTION BOX



AREA INCLUDES AIR-CON (A/C) LEDGE, BALCONY AND STRATA VOID AREA WHERE APPLICABLE. THE PLANS ARE SUBJECT TO CHANGE AS MAY BE APPROVED BY RELEVANT AUTHORITIES. ALL FLOOR PLANS ARE APPROXIMATE MEASUREMENTS ONLY AND ARE SUBJECT TO GOVERNMENT RE-SURVEY. THE BALCONY SHALL NOT BE ENCLOSED UNLESS WITH THE APPROVED BALCONY SCREEN. FOR AN ILLUSTRATION OF THE APPROVED BALCONY SCREEN, PLEASE REFER TO THE DIAGRAM ANNEXED HERETO AS "ANNEXURE A".

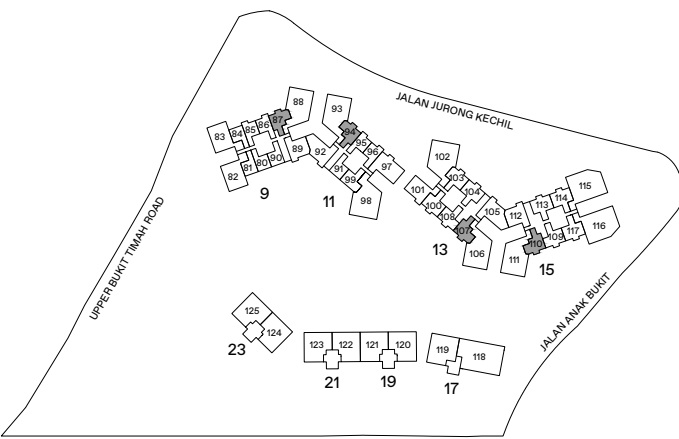

LEGEND

WD WASHER-DRYER
 W/D WASHER AND DRYER
 F FRIDGE
 DB DISTRIBUTION BOX



AREA INCLUDES AIR-CON (A/C) LEDGE, BALCONY AND STRATA VOID AREA WHERE APPLICABLE. THE PLANS ARE SUBJECT TO CHANGE AS MAY BE APPROVED BY RELEVANT AUTHORITIES. ALL FLOOR PLANS ARE APPROXIMATE MEASUREMENTS ONLY AND ARE SUBJECT TO GOVERNMENT RE-SURVEY. THE BALCONY SHALL NOT BE ENCLOSED UNLESS WITH THE APPROVED BALCONY SCREEN. FOR AN ILLUSTRATION OF THE APPROVED BALCONY SCREEN, PLEASE REFER TO THE DIAGRAM ANNEXED HERETO AS "ANNEXURE A".

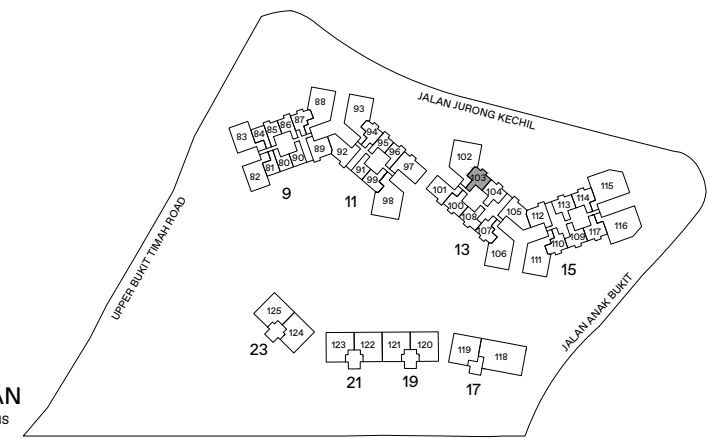

2 - BEDROOM . TYPE B5/B5A
 61 sqm | 657 sqft (B5), 62 sqm | 667 sqft (B5A)

13 Jalan Anak Bukit: #06-104 to #16-104 (B5, Mirrored)
 #18-100 to #31-100 (B5A, Mirrored)
 #18-108 to #31-108 (B5A)
 15 Jalan Anak Bukit: #06-113 to #16-113 (B5)
 #06-114 to #16-114 (B5, Mirrored)
 #18-114 to #31-114 (B5A, Mirrored)

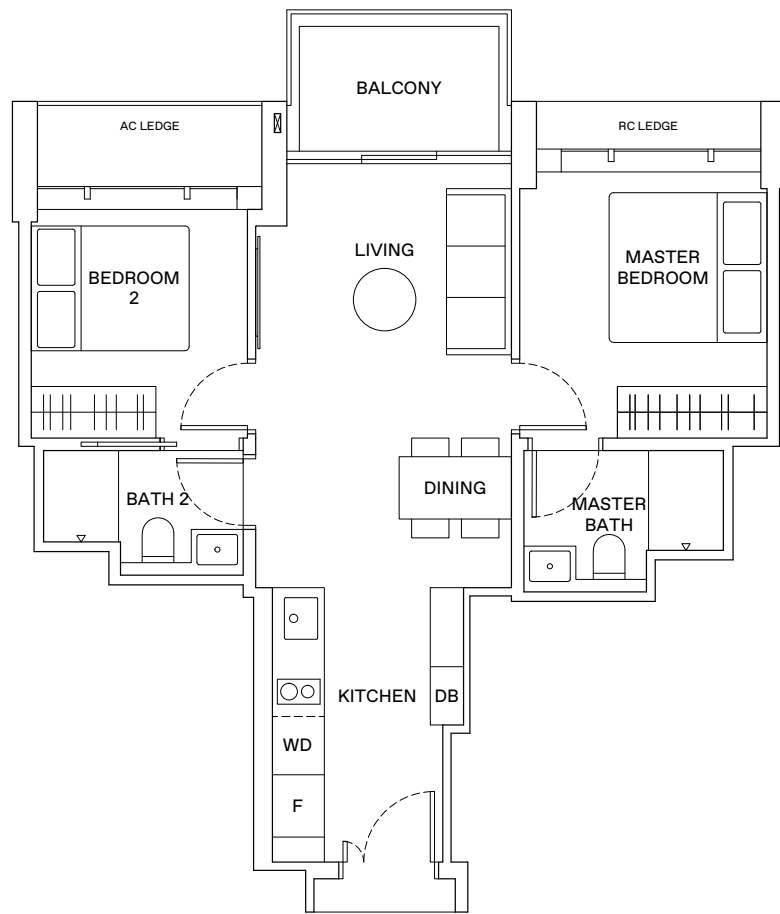
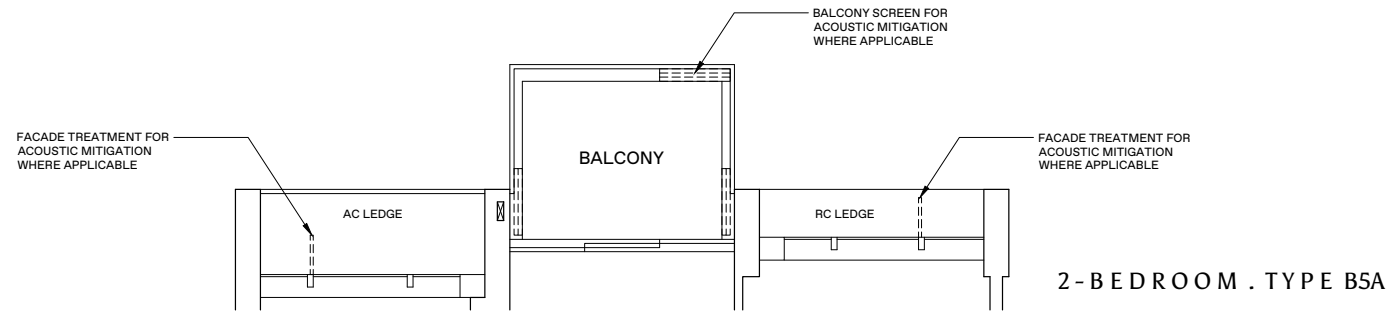

2 - BEDROOM . TYPE B6
 62 sqm | 667 sqft

13 Jalan Anak Bukit: #18-107 to #31-107

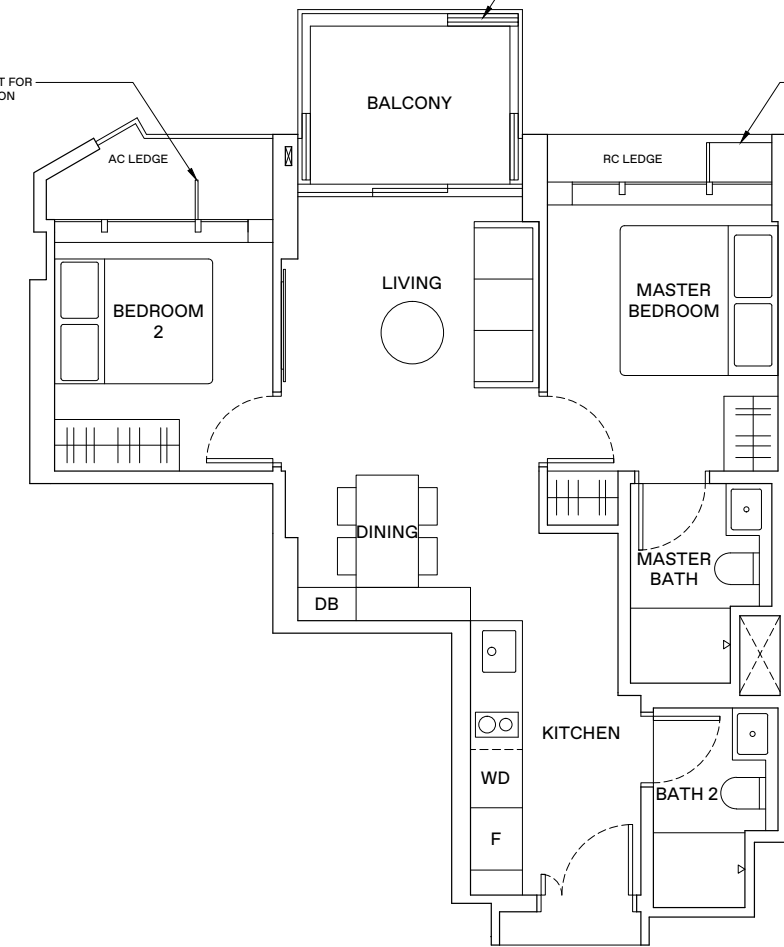
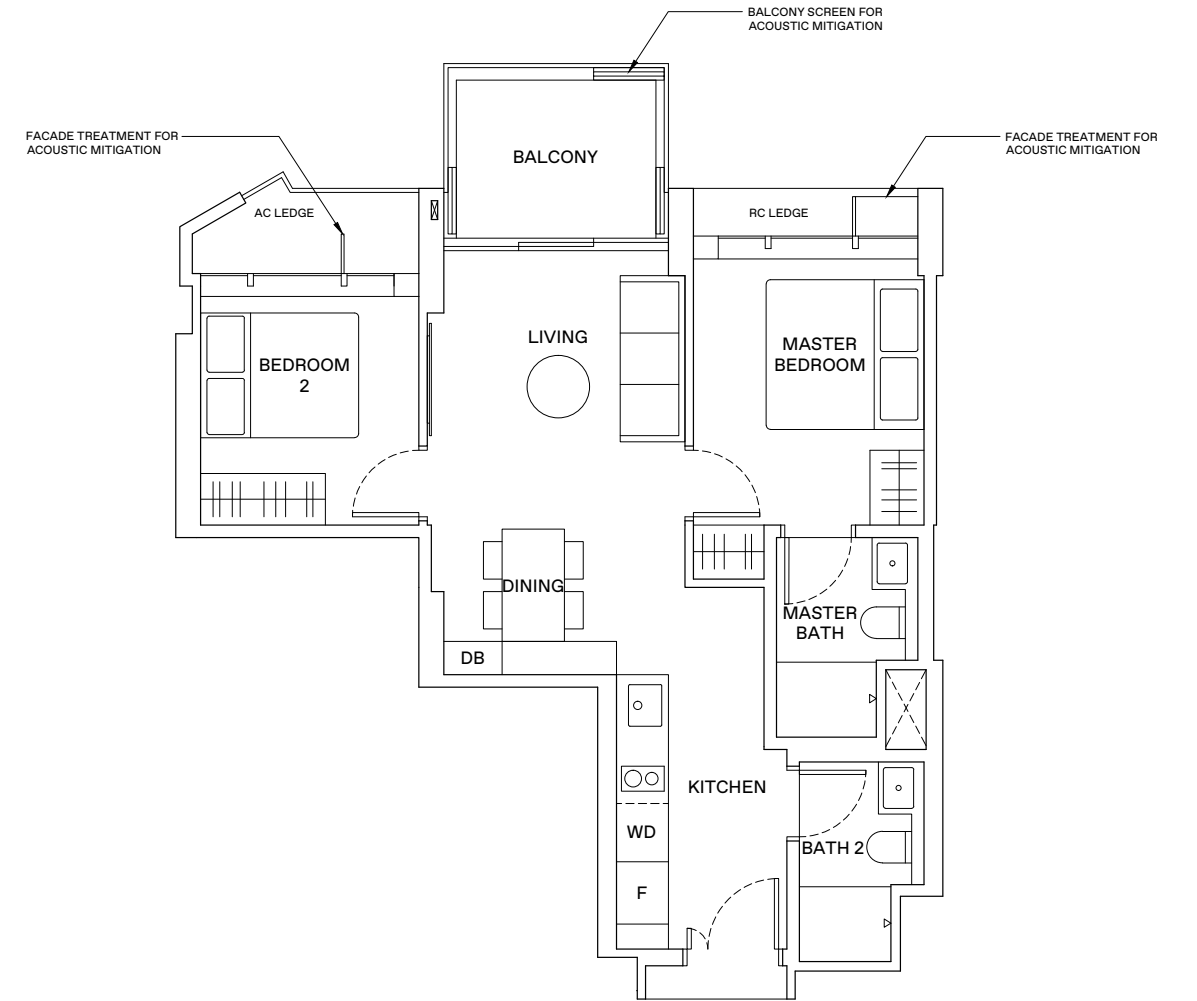

LEGEND

- WD WASHER-DRYER
- W/D WASHER AND DRYER
- F FRIDGE
- DB DISTRIBUTION BOX



AREA INCLUDES AIR-CON (A/C) LEDGE, BALCONY AND STRATA VOID AREA WHERE APPLICABLE. THE PLANS ARE SUBJECT TO CHANGE AS MAY BE APPROVED BY RELEVANT AUTHORITIES. ALL FLOOR PLANS ARE APPROXIMATE MEASUREMENTS ONLY AND ARE SUBJECT TO GOVERNMENT RE-SURVEY. THE BALCONY SHALL NOT BE ENCLOSED UNLESS WITH THE APPROVED BALCONY SCREEN. FOR AN ILLUSTRATION OF THE APPROVED BALCONY SCREEN, PLEASE REFER TO THE DIAGRAM ANNEXED HERETO AS "ANNEXURE A".

KEY PLAN
 THIS KEY PLAN IS NOT TO SCALE

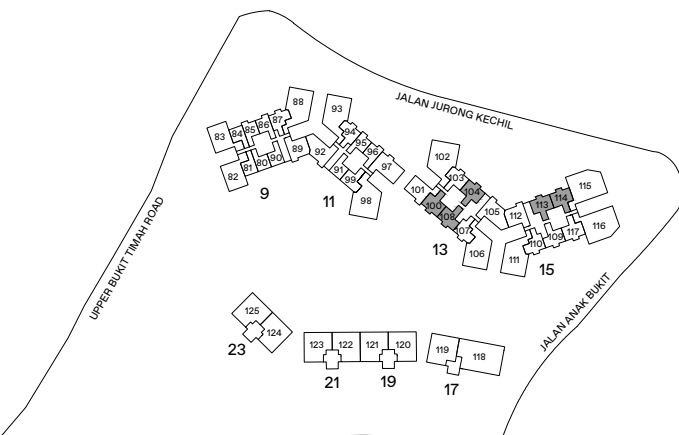

LEGEND

- WD WASHER-DRYER
- W/D WASHER AND DRYER
- F FRIDGE
- DB DISTRIBUTION BOX

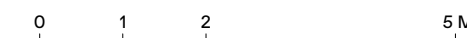

AREA INCLUDES AIR-CON (A/C) LEDGE, BALCONY AND STRATA VOID AREA WHERE APPLICABLE. THE PLANS ARE SUBJECT TO CHANGE AS MAY BE APPROVED BY RELEVANT AUTHORITIES. ALL FLOOR PLANS ARE APPROXIMATE MEASUREMENTS ONLY AND ARE SUBJECT TO GOVERNMENT RE-SURVEY. THE BALCONY SHALL NOT BE ENCLOSED UNLESS WITH THE APPROVED BALCONY SCREEN. FOR AN ILLUSTRATION OF THE APPROVED BALCONY SCREEN, PLEASE REFER TO THE DIAGRAM ANNEXED HERETO AS "ANNEXURE A".

KEY PLAN
 THIS KEY PLAN IS NOT TO SCALE

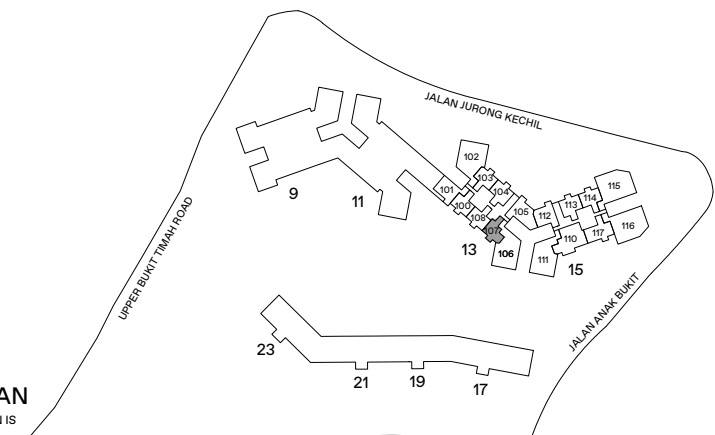

2 - BEDROOM . TYPE B7/B7A
68 sqm | 732 sqft (B7), 69 sqm | 743 sqft (B7A)

9 Jalan Anak Bukit: #06-89 to #16-89 (B7)
15 Jalan Anak Bukit: #06-112 to #16-112 (B7)
#18-112 to #30-112 (B7A)

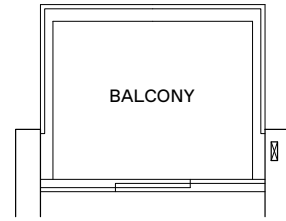

2-BEDROOM . TYPE B7A

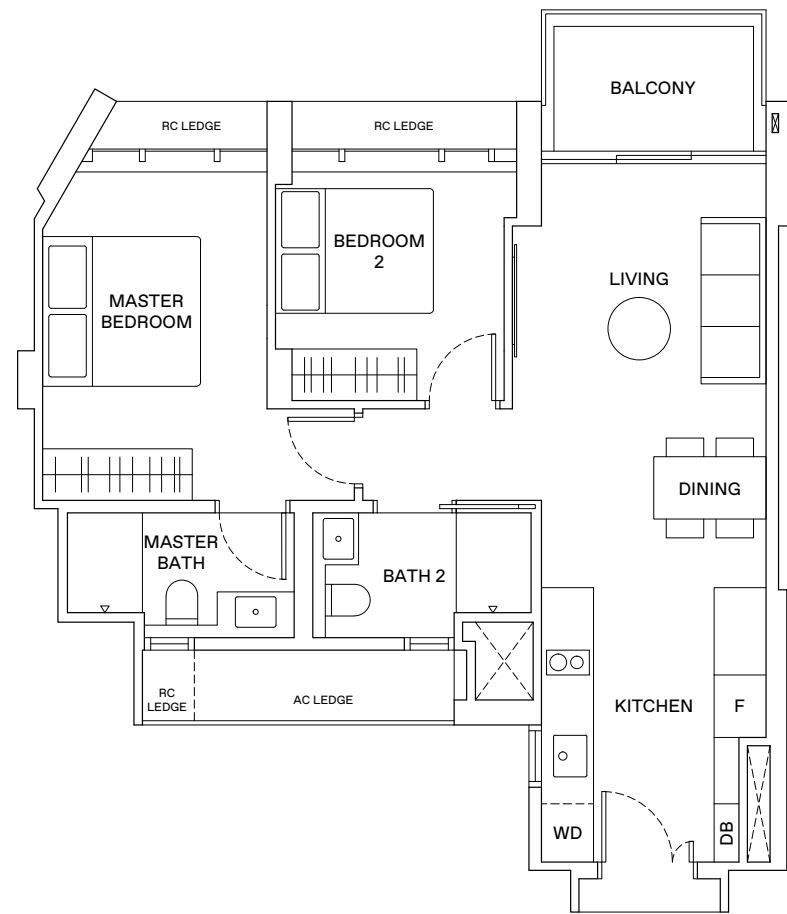

2 - BEDROOM + STUDY . TYPE B8
67 sqm | 721 sqft

13 Jalan Anak Bukit: #18-104 to #31-104 (Mirrored)
15 Jalan Anak Bukit: #18-113 to #31-113

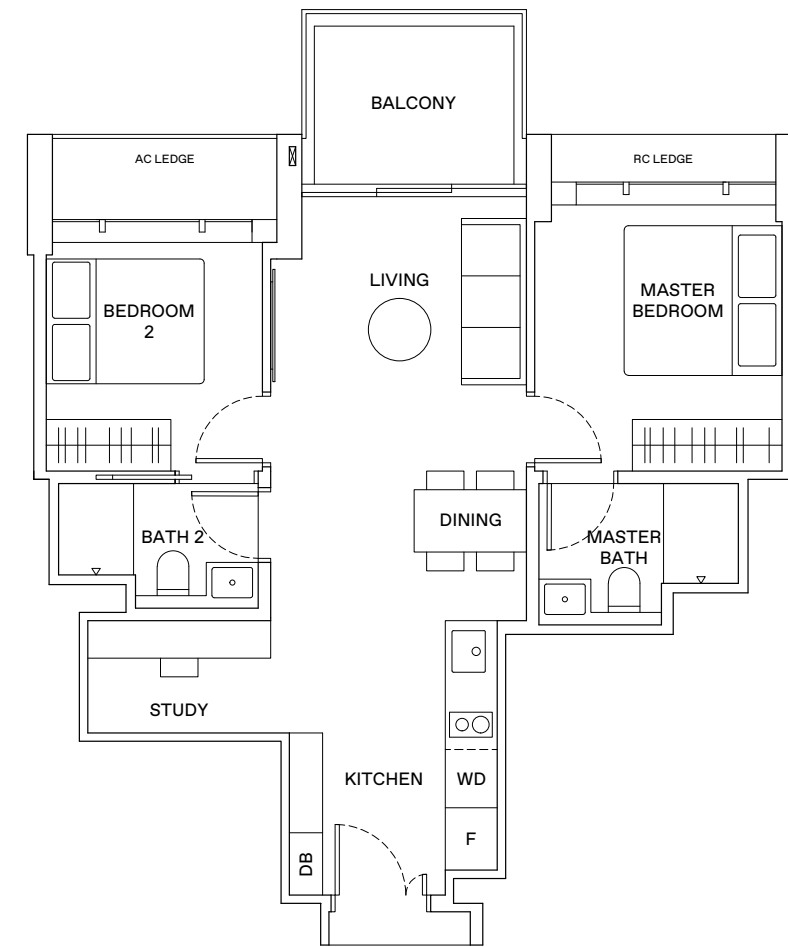

LEGEND

- WD WASHER-DRYER
- W/D WASHER AND DRYER
- F FRIDGE
- DB DISTRIBUTION BOX



AREA INCLUDES AIR-CON (A/C) LEDGE, BALCONY AND STRATA VOID AREA WHERE APPLICABLE. THE PLANS ARE SUBJECT TO CHANGE AS MAY BE APPROVED BY RELEVANT AUTHORITIES. ALL FLOOR PLANS ARE APPROXIMATE MEASUREMENTS ONLY AND ARE SUBJECT TO GOVERNMENT RE-SURVEY. THE BALCONY SHALL NOT BE ENCLOSED UNLESS WITH THE APPROVED BALCONY SCREEN. FOR AN ILLUSTRATION OF THE APPROVED BALCONY SCREEN, PLEASE REFER TO THE DIAGRAM ANNEXED HERETO AS "ANNEXURE A".

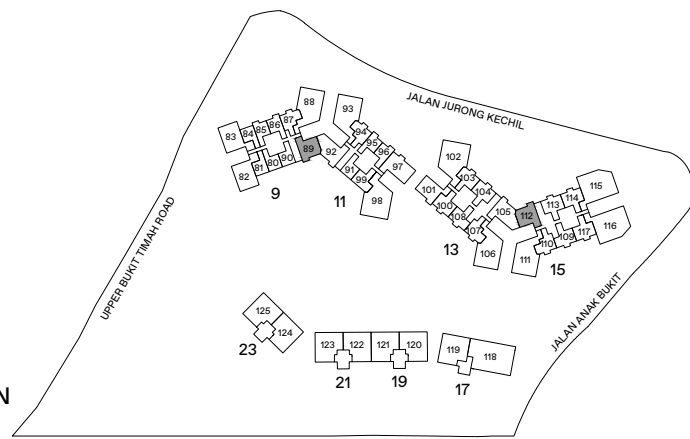

LEGEND

- WD WASHER-DRYER
- W/D WASHER AND DRYER
- F FRIDGE
- DB DISTRIBUTION BOX



AREA INCLUDES AIR-CON (A/C) LEDGE, BALCONY AND STRATA VOID AREA WHERE APPLICABLE. THE PLANS ARE SUBJECT TO CHANGE AS MAY BE APPROVED BY RELEVANT AUTHORITIES. ALL FLOOR PLANS ARE APPROXIMATE MEASUREMENTS ONLY AND ARE SUBJECT TO GOVERNMENT RE-SURVEY. THE BALCONY SHALL NOT BE ENCLOSED UNLESS WITH THE APPROVED BALCONY SCREEN. FOR AN ILLUSTRATION OF THE APPROVED BALCONY SCREEN, PLEASE REFER TO THE DIAGRAM ANNEXED HERETO AS "ANNEXURE A".

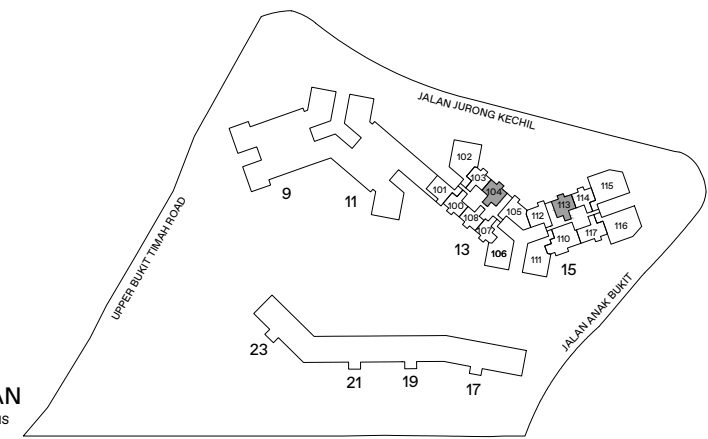

2 - BEDROOM + STUDY . TYPE B9/B9P

74 sqm | 797 sqft (B9, B9P)

13 Jalan Anak Bukit: #05-101 (B9P)
#06-101 to #16-101 (B9)

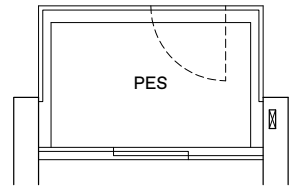

2 - BEDROOM . TYPE B9P

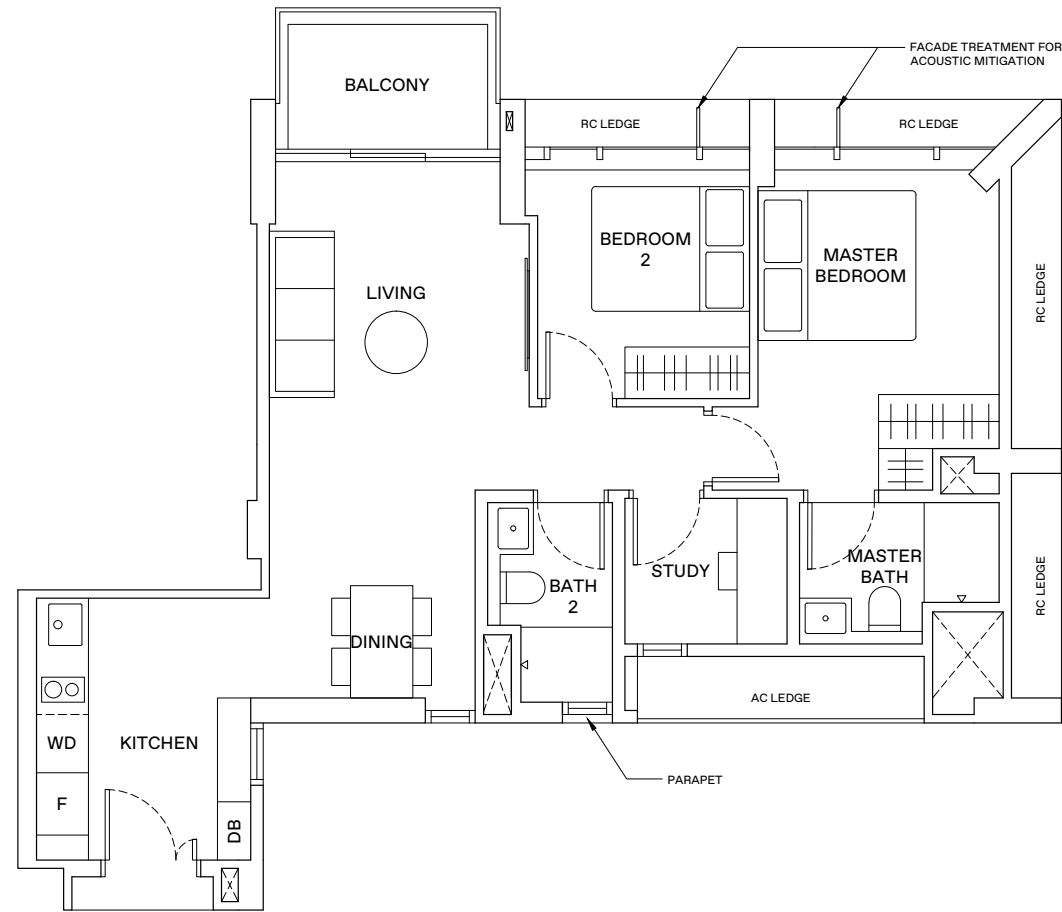

LEGEND

- WD WASHER-DRYER
- W/D WASHER AND DRYER
- F FRIDGE
- DB DISTRIBUTION BOX



AREA INCLUDES AIR-CON (A/C) LEDGE, BALCONY AND STRATA VOID AREA WHERE APPLICABLE. THE PLANS ARE SUBJECT TO CHANGE AS MAY BE APPROVED BY RELEVANT AUTHORITIES. ALL FLOOR PLANS ARE APPROXIMATE MEASUREMENTS ONLY AND ARE SUBJECT TO GOVERNMENT RE-SURVEY. THE BALCONY SHALL NOT BE ENCLOSED UNLESS WITH THE APPROVED BALCONY SCREEN. FOR AN ILLUSTRATION OF THE APPROVED BALCONY SCREEN, PLEASE REFER TO THE DIAGRAM ANNEXED HERETO AS 'ANNEXURE A'.



THIS KEY PLAN IS NOT TO SCALE

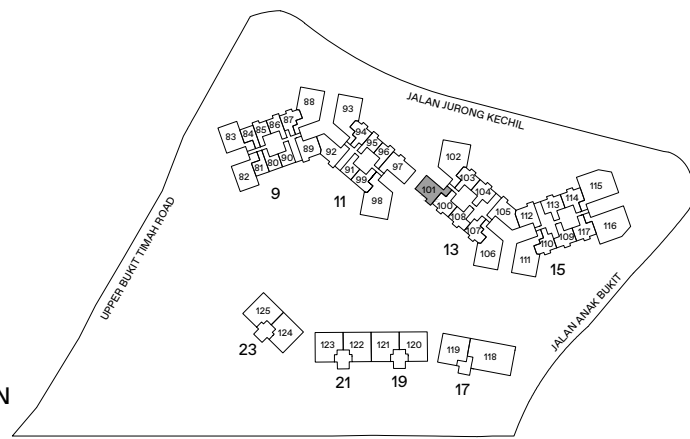

2 - BEDROOM + STUDY . TYPE B9A

75 sqm | 807 sqft

13 Jalan Anak Bukit: #18-101 to #31-101

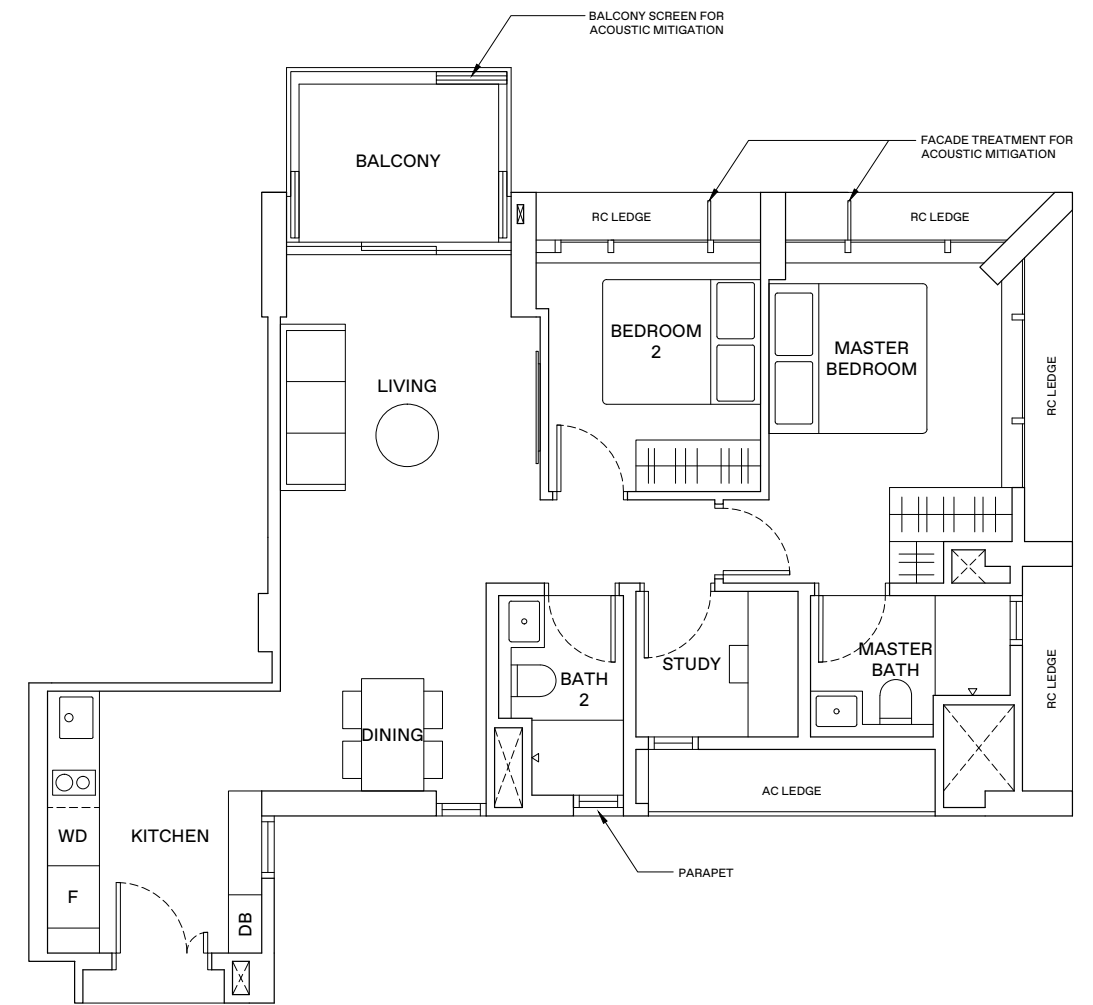

LEGEND

- WD WASHER-DRYER
- W/D WASHER AND DRYER
- F FRIDGE
- DB DISTRIBUTION BOX



AREA INCLUDES AIR-CON (A/C) LEDGE, BALCONY AND STRATA VOID AREA WHERE APPLICABLE. THE PLANS ARE SUBJECT TO CHANGE AS MAY BE APPROVED BY RELEVANT AUTHORITIES. ALL FLOOR PLANS ARE APPROXIMATE MEASUREMENTS ONLY AND ARE SUBJECT TO GOVERNMENT RE-SURVEY. THE BALCONY SHALL NOT BE ENCLOSED UNLESS WITH THE APPROVED BALCONY SCREEN. FOR AN ILLUSTRATION OF THE APPROVED BALCONY SCREEN, PLEASE REFER TO THE DIAGRAM ANNEXED HERETO AS 'ANNEXURE A'.



THIS KEY PLAN IS NOT TO SCALE

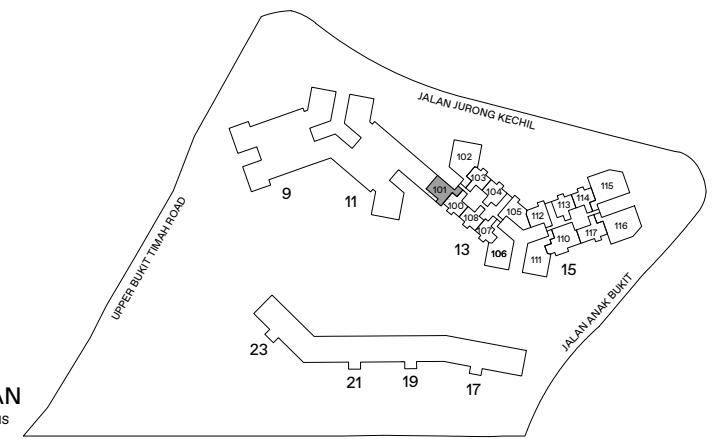

3-BEDROOM . TYPE C1

82 sqm | 883 sqft

15 Jalan Anak Bukit: #18-117 to #31-117

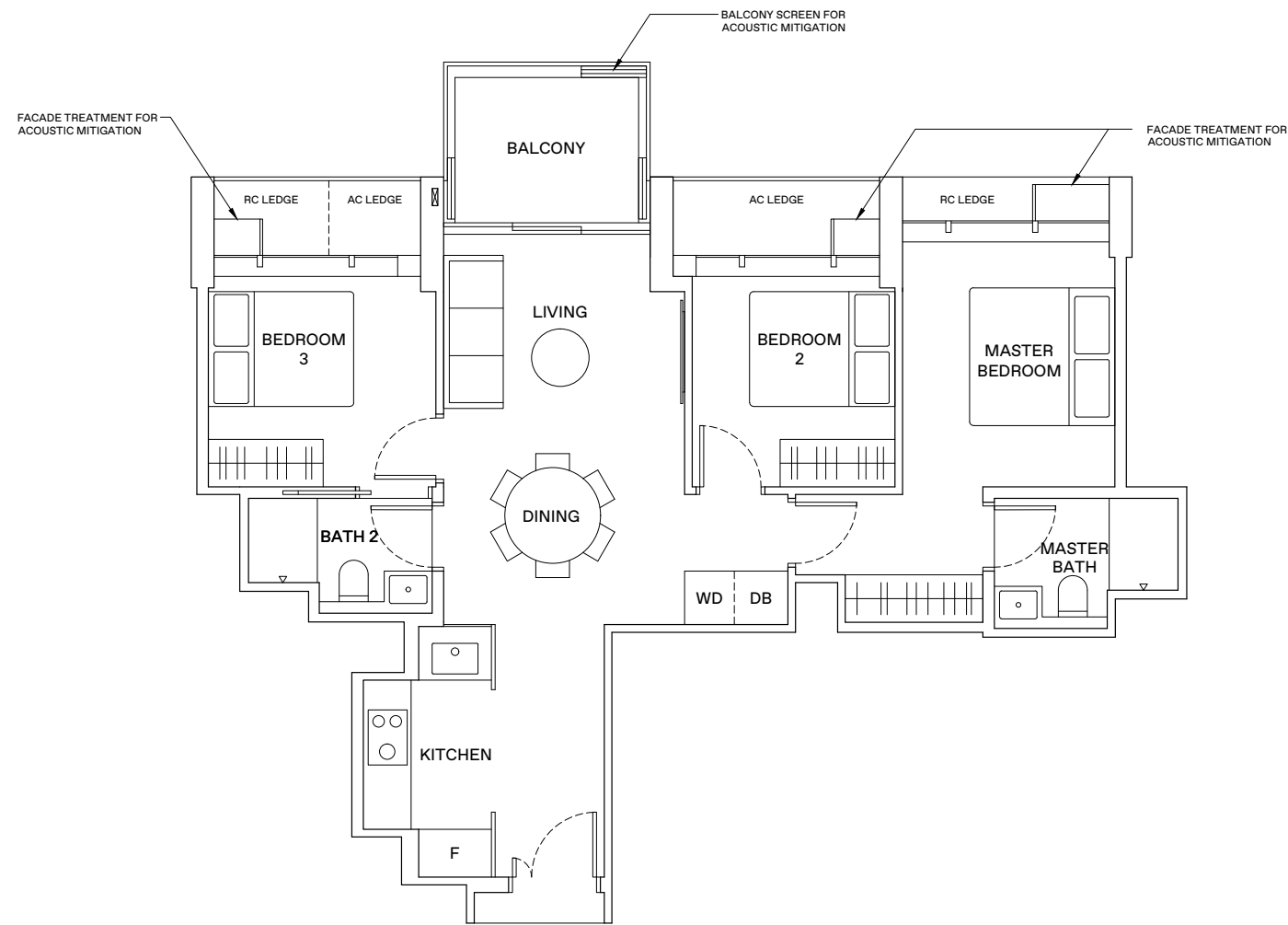

LEGEND

- WD WASHER-DRYER
- W/D WASHER AND DRYER
- F FRIDGE
- DB DISTRIBUTION BOX



AREA INCLUDES AIR-CON (A/C) LEDGE, BALCONY AND STRATA VOID AREA WHERE APPLICABLE. THE PLANS ARE SUBJECT TO CHANGE AS MAY BE APPROVED BY RELEVANT AUTHORITIES. ALL FLOOR PLANS ARE APPROXIMATE MEASUREMENTS ONLY AND ARE SUBJECT TO GOVERNMENT RE-SURVEY. THE BALCONY SHALL NOT BE ENCLOSED UNLESS WITH THE APPROVED BALCONY SCREEN. FOR AN ILLUSTRATION OF THE APPROVED BALCONY SCREEN, PLEASE REFER TO THE DIAGRAM ANNEXED HERETO AS "ANNEXURE A".

KEY PLAN
THIS KEY PLAN IS NOT TO SCALE

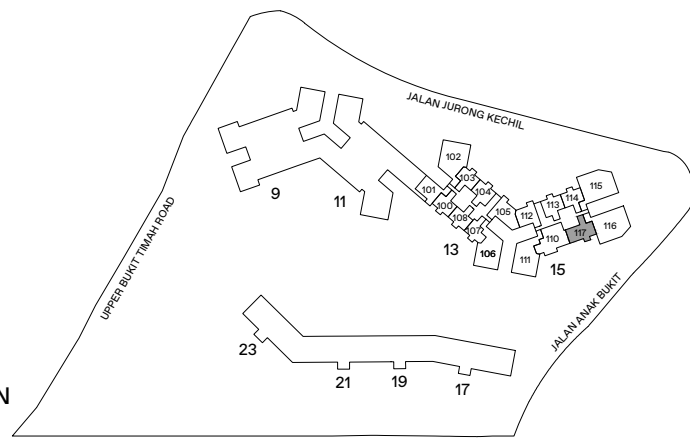

3-BEDROOM . TYPE C2/C2A

87 sqm | 936 sqft (C2), 88 sqm | 947 sqft (C2A)

11 Jalan Anak Bukit: #06-92 to #16-92 (C2)
13 Jalan Anak Bukit: #06-105 to #16-105 (C2)
#18-105 to #30-105 (C2A)

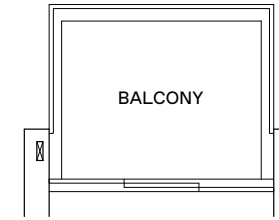

3-BEDROOM . TYPE C2A

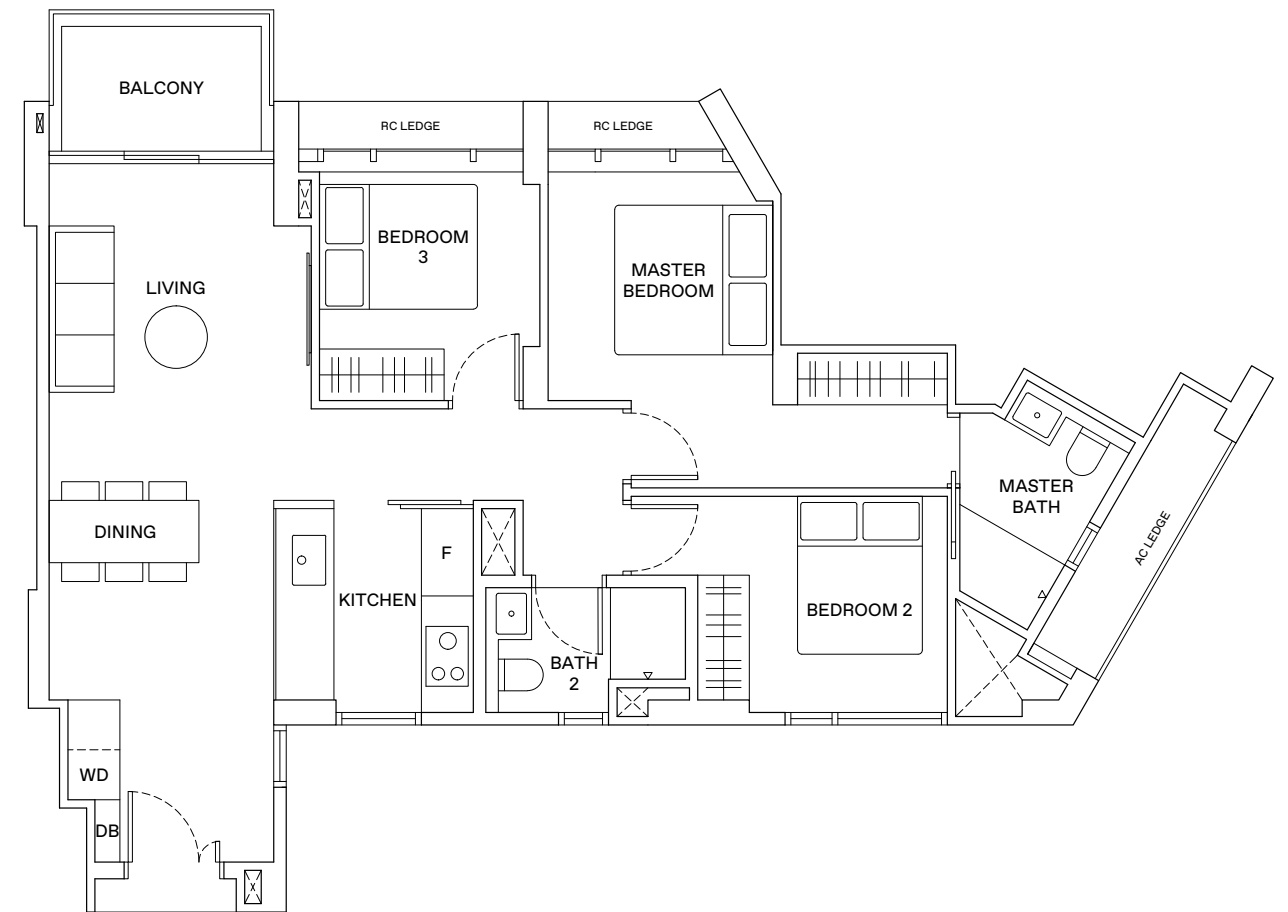

LEGEND

- WD WASHER-DRYER
- W/D WASHER AND DRYER
- F FRIDGE
- DB DISTRIBUTION BOX



AREA INCLUDES AIR-CON (A/C) LEDGE, BALCONY AND STRATA VOID AREA WHERE APPLICABLE. THE PLANS ARE SUBJECT TO CHANGE AS MAY BE APPROVED BY RELEVANT AUTHORITIES. ALL FLOOR PLANS ARE APPROXIMATE MEASUREMENTS ONLY AND ARE SUBJECT TO GOVERNMENT RE-SURVEY. THE BALCONY SHALL NOT BE ENCLOSED UNLESS WITH THE APPROVED BALCONY SCREEN. FOR AN ILLUSTRATION OF THE APPROVED BALCONY SCREEN, PLEASE REFER TO THE DIAGRAM ANNEXED HERETO AS "ANNEXURE A".

KEY PLAN
THIS KEY PLAN IS NOT TO SCALE

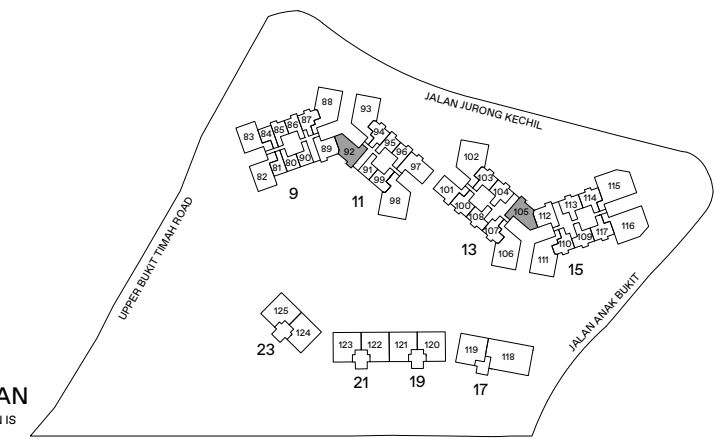

3-BEDROOM . TYPE C3

89 sqm | 958 sqft

11 Jalan Anak Bukit: #06-97 to #16-97

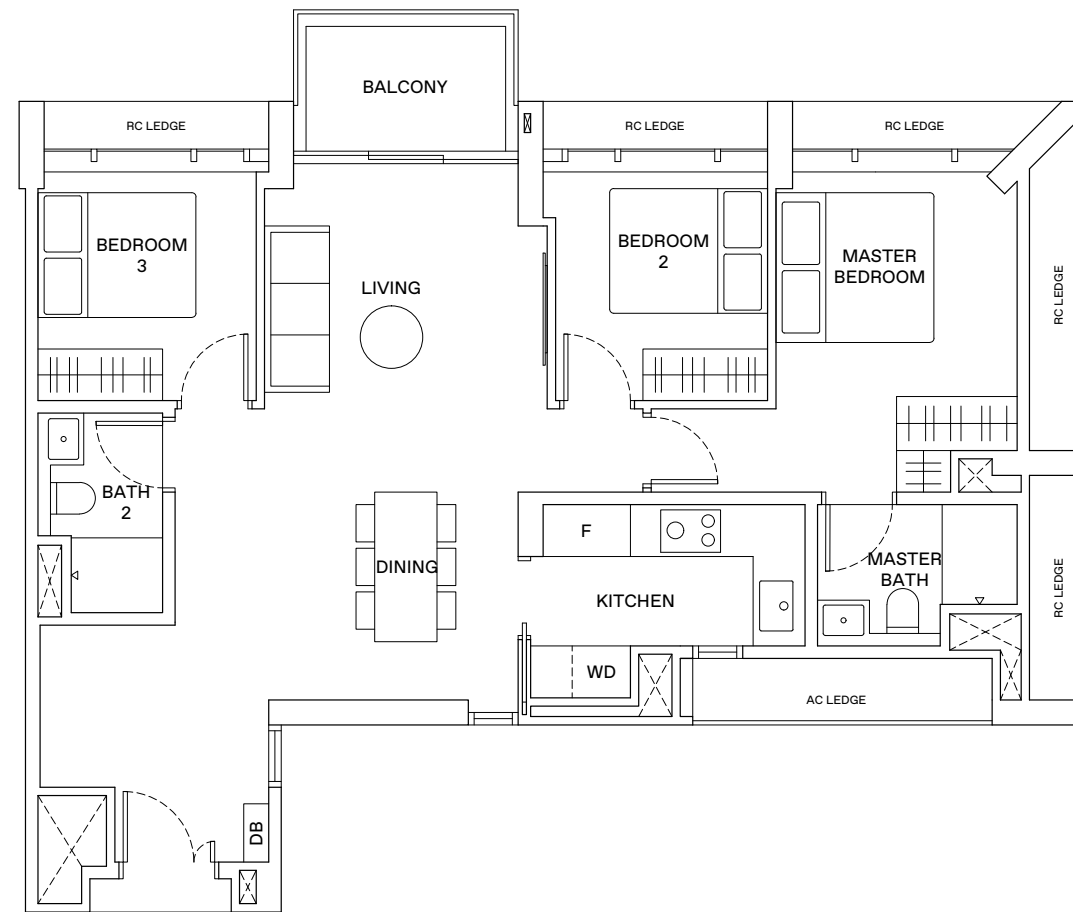

LEGEND

- WD WASHER-DRYER
- W/D WASHER AND DRYER
- F FRIDGE
- DB DISTRIBUTION BOX



AREA INCLUDES AIR-CON (A/C) LEDGE, BALCONY AND STRATA VOID AREA WHERE APPLICABLE. THE PLANS ARE SUBJECT TO CHANGE AS MAY BE APPROVED BY RELEVANT AUTHORITIES. ALL FLOOR PLANS ARE APPROXIMATE MEASUREMENTS ONLY AND ARE SUBJECT TO GOVERNMENT RE-SURVEY. THE BALCONY SHALL NOT BE ENCLOSED UNLESS WITH THE APPROVED BALCONY SCREEN. FOR AN ILLUSTRATION OF THE APPROVED BALCONY SCREEN, PLEASE REFER TO THE DIAGRAM ANNEXED HERETO AS "ANNEXURE A".

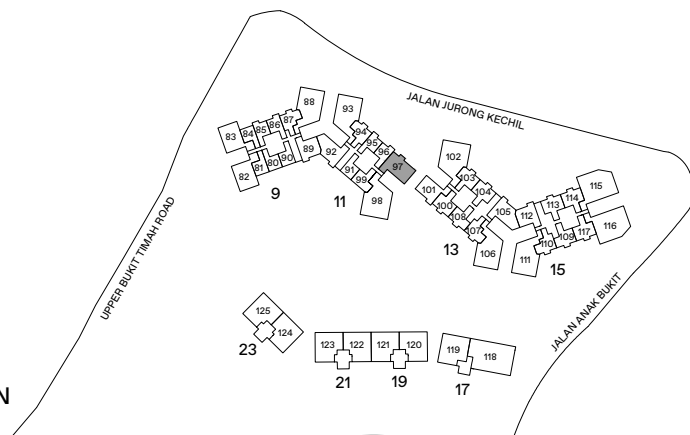

3-BEDROOM . TYPE C4/C4P

97 sqm | 1,044 sqft (C4, C4P)

9 Jalan Anak Bukit: #05-82 (C4P)
 #06-82 to #16-82 (C4)
 #05-83 to #16-83 (C4, Mirrored)

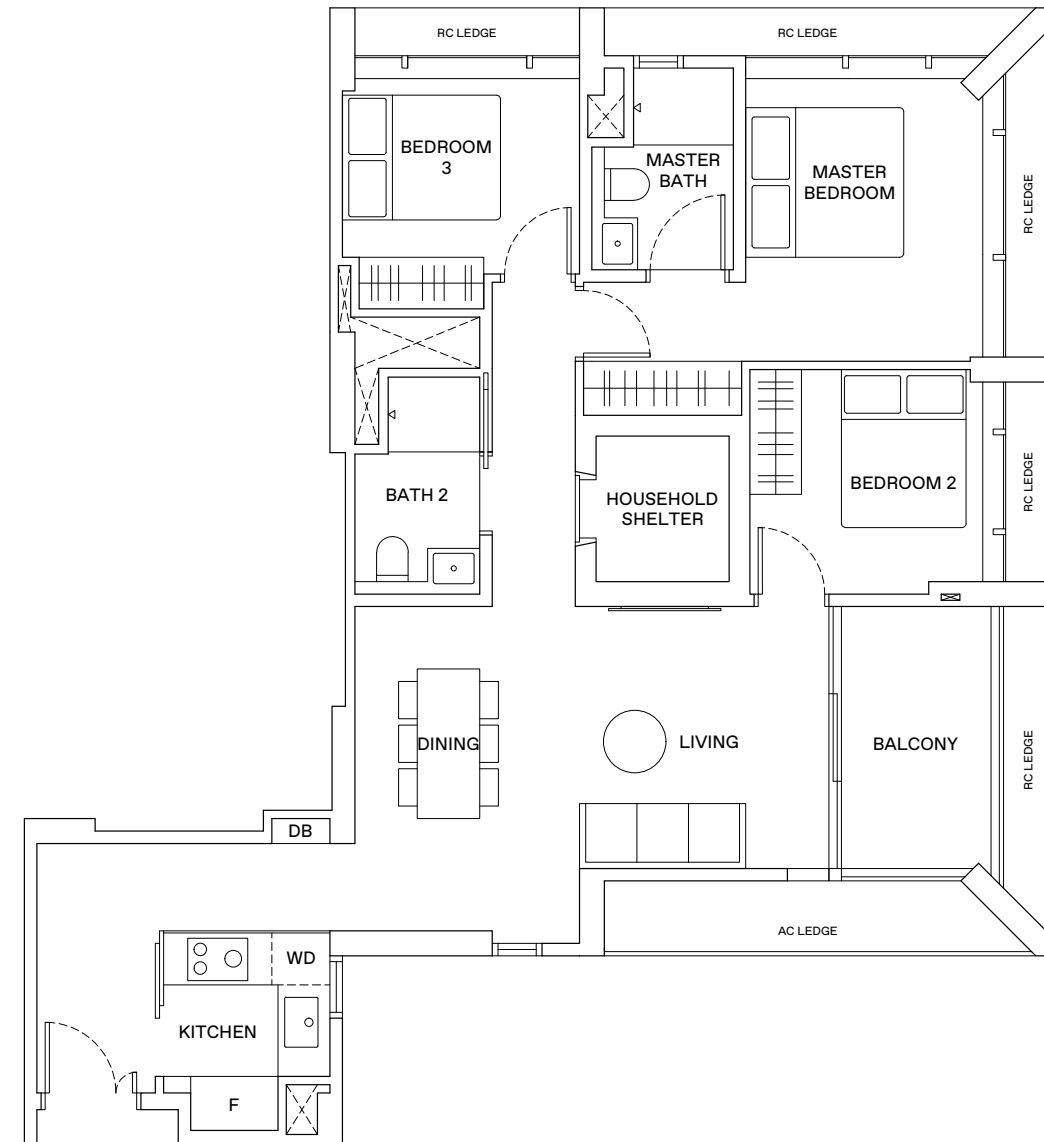

LEGEND

- WD WASHER-DRYER
- W/D WASHER AND DRYER
- F FRIDGE
- DB DISTRIBUTION BOX



AREA INCLUDES AIR-CON (A/C) LEDGE, BALCONY AND STRATA VOID AREA WHERE APPLICABLE. THE PLANS ARE SUBJECT TO CHANGE AS MAY BE APPROVED BY RELEVANT AUTHORITIES. ALL FLOOR PLANS ARE APPROXIMATE MEASUREMENTS ONLY AND ARE SUBJECT TO GOVERNMENT RE-SURVEY. THE BALCONY SHALL NOT BE ENCLOSED UNLESS WITH THE APPROVED BALCONY SCREEN. FOR AN ILLUSTRATION OF THE APPROVED BALCONY SCREEN, PLEASE REFER TO THE DIAGRAM ANNEXED HERETO AS "ANNEXURE A".

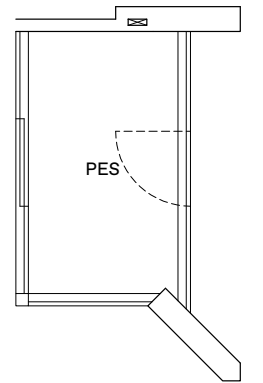
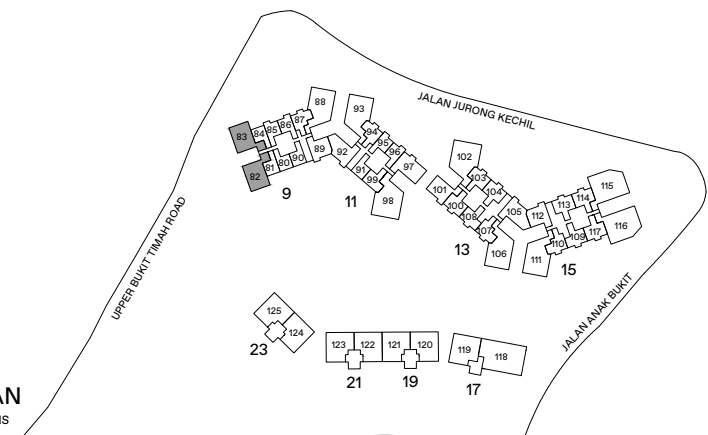

3-BEDROOM . TYPE C4P

3-BEDROOM + STUDY . TYPE C5

113 sqm | 1,216 sqft

15 Jalan Anak Bukit: #18-110 to #31-110

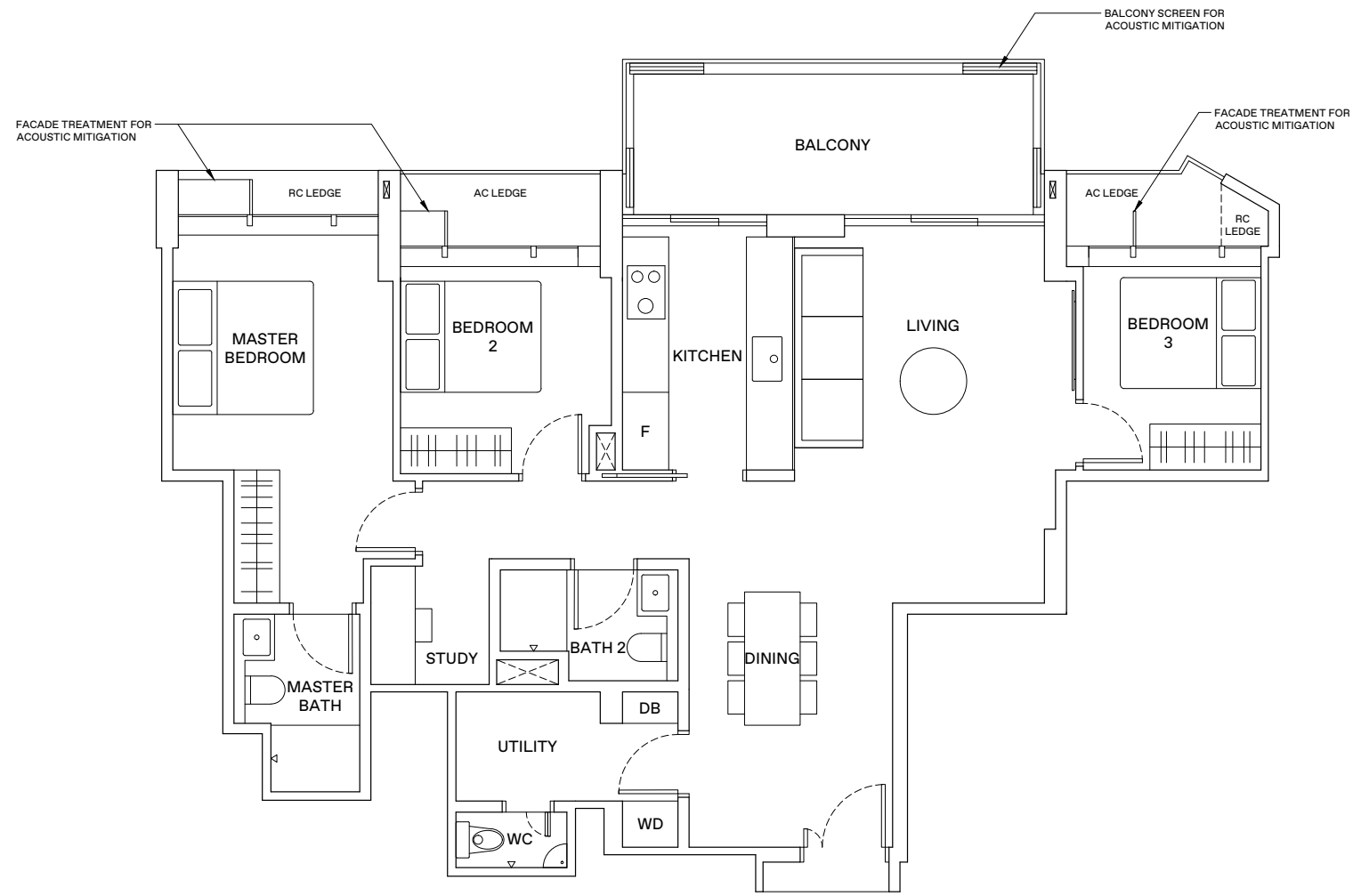

HORIZON

FLOOR PLANS

LEGEND

- WD WASHER-DRYER
- W/D WASHER AND DRYER
- F FRIDGE
- DB DISTRIBUTION BOX



AREA INCLUDES AIR-CON (A/C) LEDGE, BALCONY AND STRATA VOID AREA WHERE APPLICABLE. THE PLANS ARE SUBJECT TO CHANGE AS MAY BE APPROVED BY RELEVANT AUTHORITIES. ALL FLOOR PLANS ARE APPROXIMATE MEASUREMENTS ONLY AND ARE SUBJECT TO GOVERNMENT RE-SURVEY. THE BALCONY SHALL NOT BE ENCLOSED UNLESS WITH THE APPROVED BALCONY SCREEN. FOR AN ILLUSTRATION OF THE APPROVED BALCONY SCREEN, PLEASE REFER TO THE DIAGRAM ANNEXED HERETO AS 'ANNEXURE A'.

KEY PLAN
THIS KEY PLAN IS NOT TO SCALE

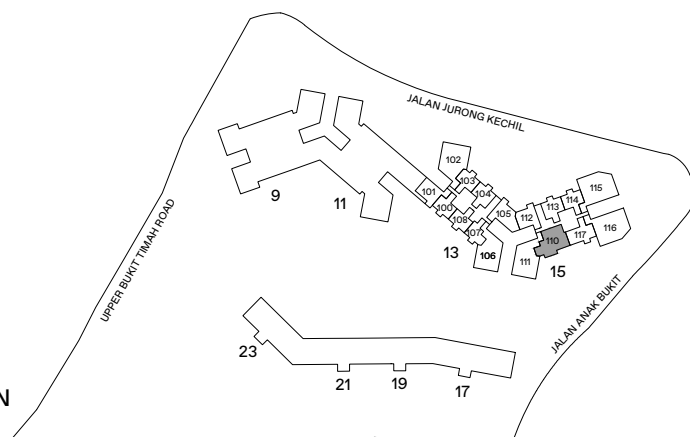

3 - BEDROOM . TYPE C9/C9P
 122 sqm | 1,313 sqft (C9, C9P)

9 Jalan Anak Bukit: #05-88 to #16-88 (C9)
 15 Jalan Anak Bukit: #05-111 (C9P)
 #06-111 to #16-111, #18-111 to #31-111 (C9)

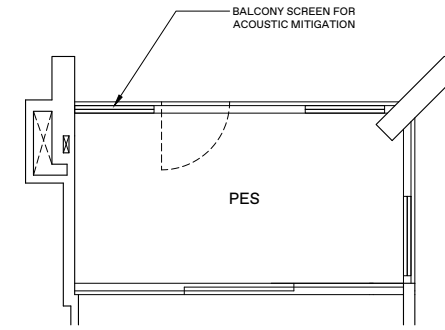
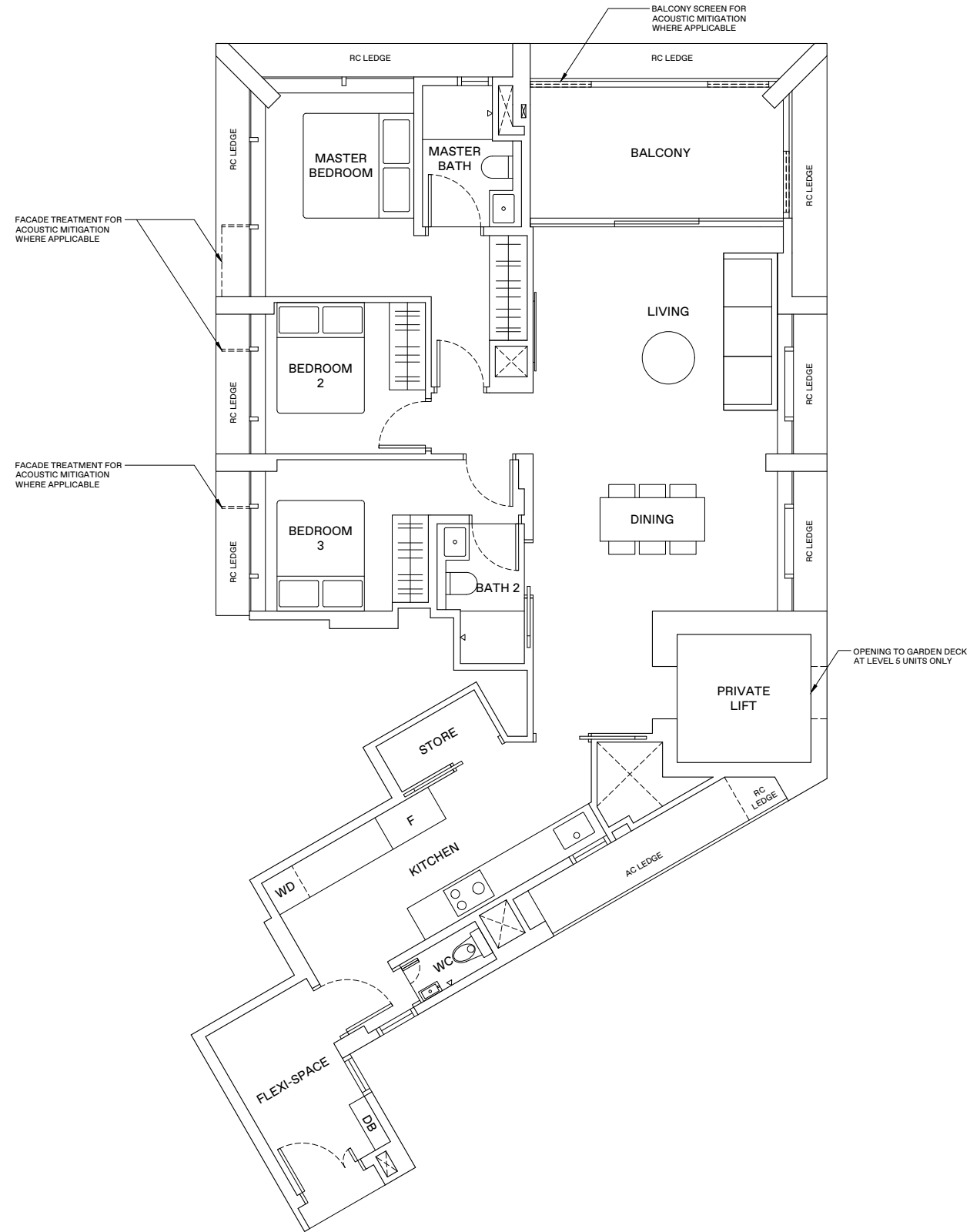

3 - BEDROOM . TYPE C9P

LEGEND

- WD WASHER-DRYER
- W/D WASHER AND DRYER
- F FRIDGE
- DB DISTRIBUTION BOX



AREA INCLUDES AIR-CON (A/C) LEDGE, BALCONY AND STRATA VOID AREA WHERE APPLICABLE. THE PLANS ARE SUBJECT TO CHANGE AS MAY BE APPROVED BY RELEVANT AUTHORITIES. ALL FLOOR PLANS ARE APPROXIMATE MEASUREMENTS ONLY AND ARE SUBJECT TO GOVERNMENT RE-SURVEY. THE BALCONY SHALL NOT BE ENCLOSED UNLESS WITH THE APPROVED BALCONY SCREEN. FOR AN ILLUSTRATION OF THE APPROVED BALCONY SCREEN, PLEASE REFER TO THE DIAGRAM ANNEXED HERETO AS "ANNEXURE A".

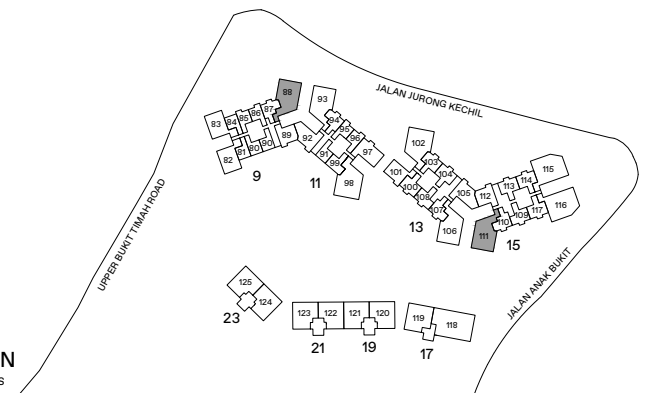

3 - BEDROOM . TYPE C10/C10P
 123 sqm | 1,324 sqft (C10, C10P)

11 Jalan Anak Bukit: #05-93 to #16-93 (C10)
 13 Jalan Anak Bukit: #05-106 (C10P)
 #06-106 to #16-106, #18-106 to #31-106 (C10)

3 - BEDROOM . TYPE C10P

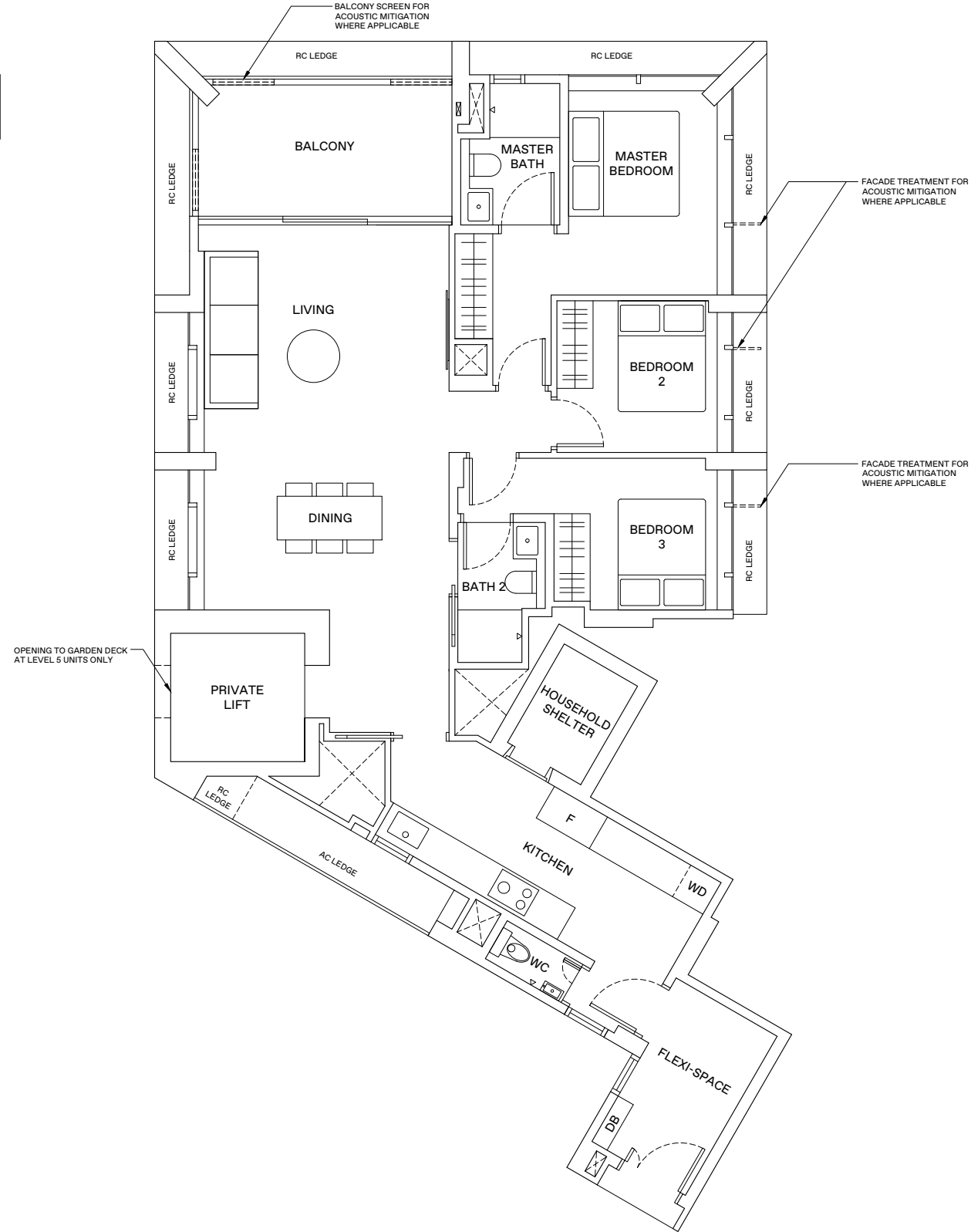
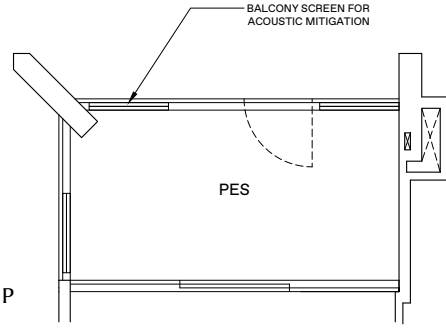

LEGEND

- WD WASHER-DRYER
- W/D WASHER AND DRYER
- F FRIDGE
- DB DISTRIBUTION BOX



AREA INCLUDES AIR-CON (A/C) LEDGE, BALCONY AND STRATA VOID AREA WHERE APPLICABLE. THE PLANS ARE SUBJECT TO CHANGE AS MAY BE APPROVED BY RELEVANT AUTHORITIES. ALL FLOOR PLANS ARE APPROXIMATE MEASUREMENTS ONLY AND ARE SUBJECT TO GOVERNMENT RE-SURVEY. THE BALCONY SHALL NOT BE ENCLOSED UNLESS WITH THE APPROVED BALCONY SCREEN. FOR AN ILLUSTRATION OF THE APPROVED BALCONY SCREEN, PLEASE REFER TO THE DIAGRAM ANNEXED HERETO AS "ANNEXURE A".

KEY PLAN
 THIS KEY PLAN IS NOT TO SCALE

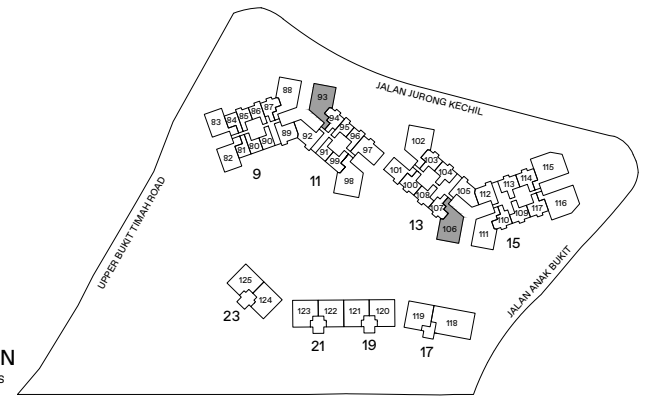

4 - BEDROOM . TYPE D2
137 sqm | 1,475 sqft

11 Jalan Anak Bukit: #06-98 to #16-98
13 Jalan Anak Bukit: #06-102 to #16-102, #18-102 to #31-102

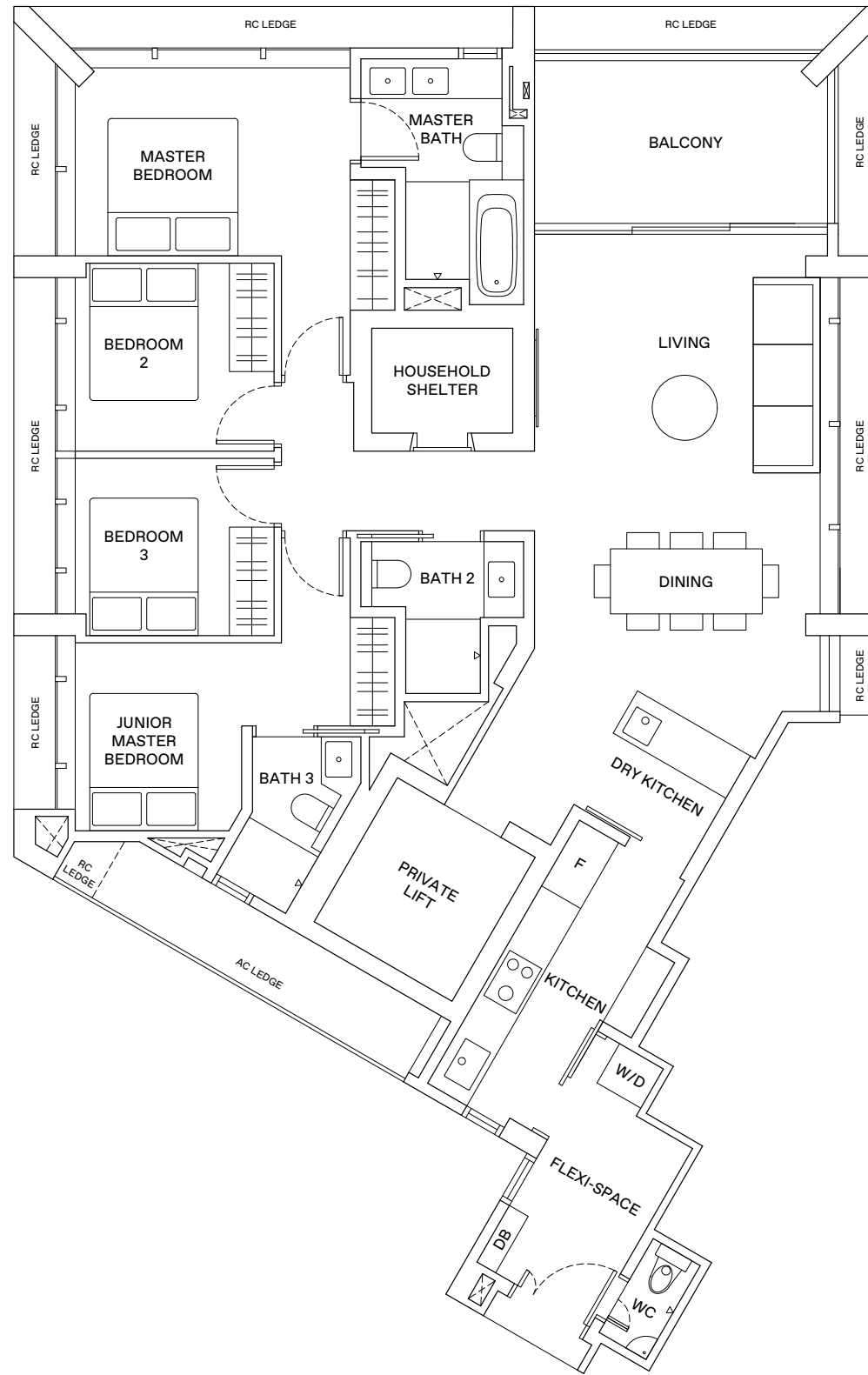

LEGEND

- WD WASHER-DRYER
- W/D WASHER AND DRYER
- F FRIDGE
- DB DISTRIBUTION BOX



AREA INCLUDES AIR-CON (A/C) LEDGE, BALCONY AND STRATA VOID AREA WHERE APPLICABLE. THE PLANS ARE SUBJECT TO CHANGE AS MAY BE APPROVED BY RELEVANT AUTHORITIES. ALL FLOOR PLANS ARE APPROXIMATE MEASUREMENTS ONLY AND ARE SUBJECT TO GOVERNMENT RE-SURVEY. THE BALCONY SHALL NOT BE ENCLOSED UNLESS WITH THE APPROVED BALCONY SCREEN. FOR AN ILLUSTRATION OF THE APPROVED BALCONY SCREEN, PLEASE REFER TO THE DIAGRAM ANNEXED HERETO AS 'ANNEXURE A'.

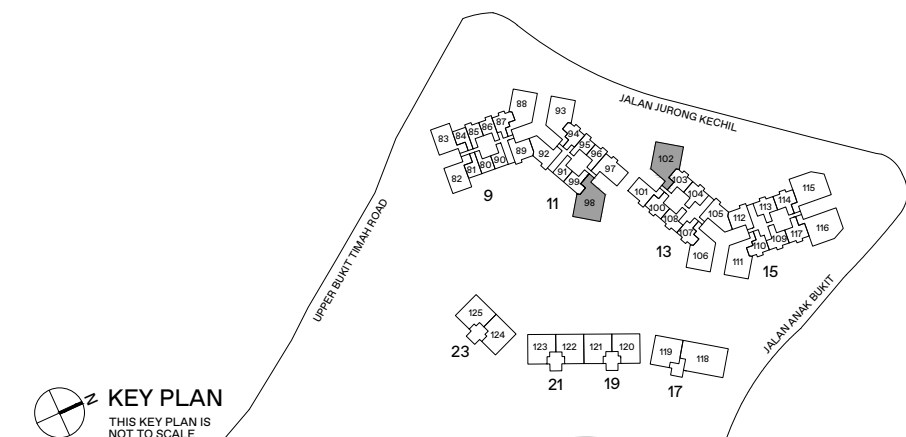

4 - BEDROOM . TYPE D2P
137 sqm | 1,475 sqft

11 Jalan Anak Bukit: #05-98

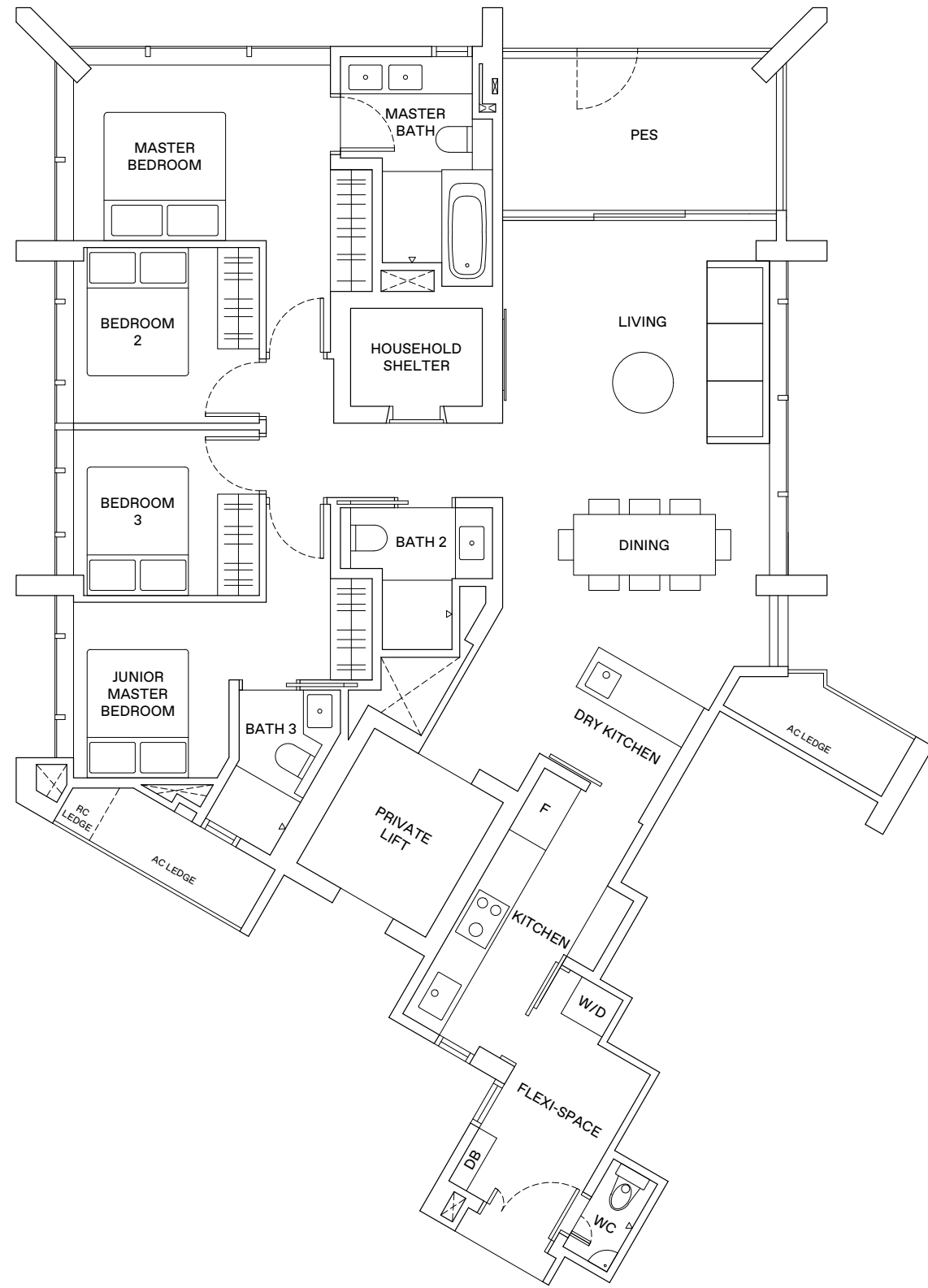

LEGEND

- WD WASHER-DRYER
- W/D WASHER AND DRYER
- F FRIDGE
- DB DISTRIBUTION BOX



AREA INCLUDES AIR-CON (A/C) LEDGE, BALCONY AND STRATA VOID AREA WHERE APPLICABLE. THE PLANS ARE SUBJECT TO CHANGE AS MAY BE APPROVED BY RELEVANT AUTHORITIES. ALL FLOOR PLANS ARE APPROXIMATE MEASUREMENTS ONLY AND ARE SUBJECT TO GOVERNMENT RE-SURVEY. THE BALCONY SHALL NOT BE ENCLOSED UNLESS WITH THE APPROVED BALCONY SCREEN. FOR AN ILLUSTRATION OF THE APPROVED BALCONY SCREEN, PLEASE REFER TO THE DIAGRAM ANNEXED HERETO AS 'ANNEXURE A'.

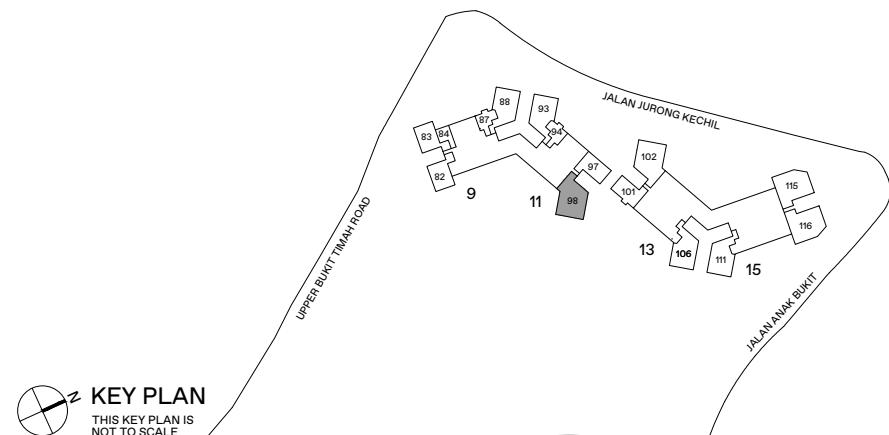

KEY PLAN
THIS KEY PLAN IS NOT TO SCALE

4 - BEDROOM . TYPE D3

151 sqm | 1,625 sqft

15 Jalan Anak Bukit: #05-115 (Mirrored)
#05-116

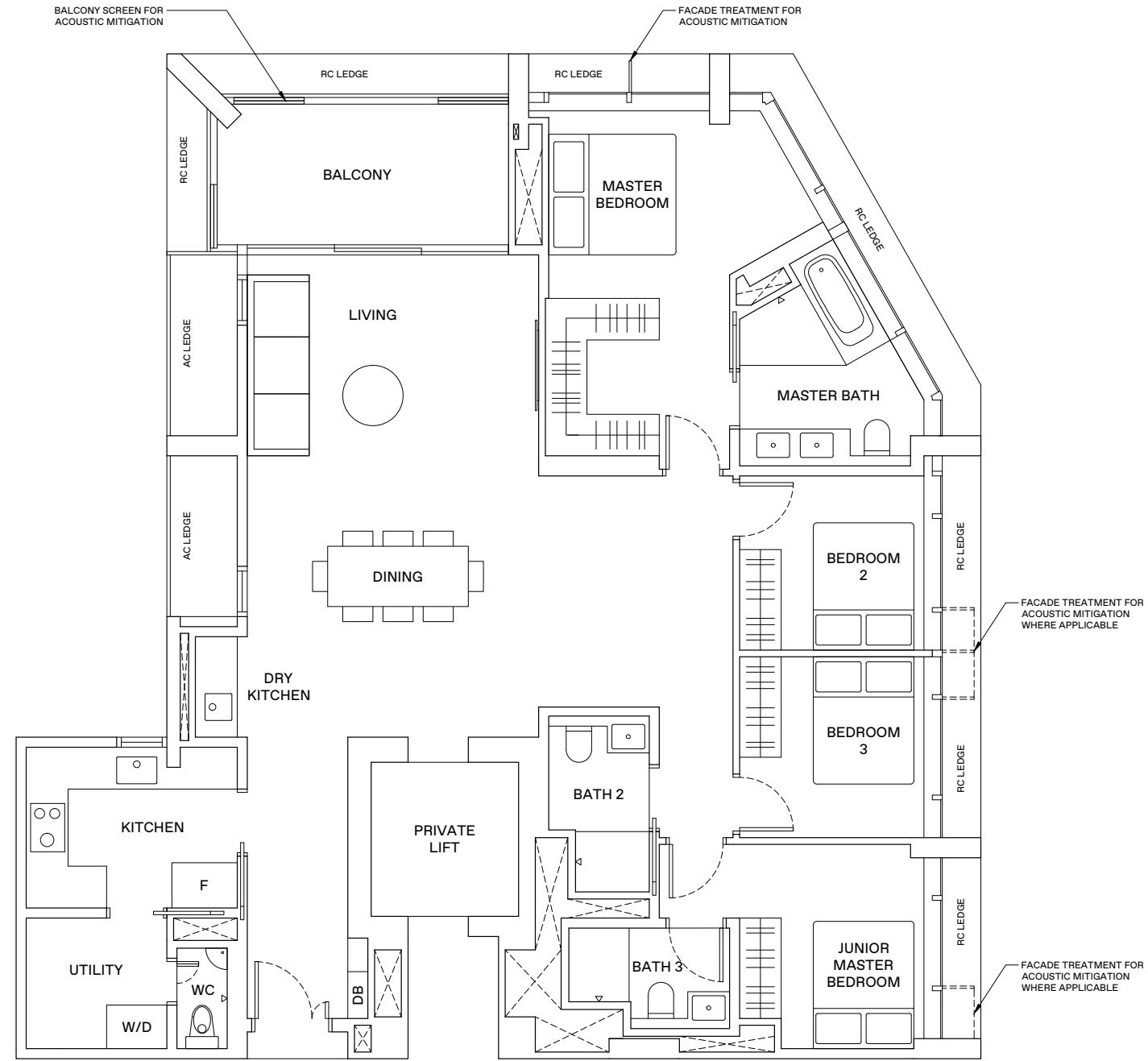

LEGEND

WD	WASHER-DRYER
W/D	WASHER AND DRYER
F	FRIDGE
DB	DISTRIBUTION BOX



AREA INCLUDES AIR-CON (A/C) LEDGE, BALCONY AND STRATA VOID AREA WHERE APPLICABLE. THE PLANS ARE SUBJECT TO CHANGE AS MAY BE APPROVED BY RELEVANT AUTHORITIES. ALL FLOOR PLANS ARE APPROXIMATE MEASUREMENTS ONLY AND ARE SUBJECT TO GOVERNMENT RE-SURVEY. THE BALCONY SHALL NOT BE ENCLOSED UNLESS WITH THE APPROVED BALCONY SCREEN. FOR AN ILLUSTRATION OF THE APPROVED BALCONY SCREEN, PLEASE REFER TO THE DIAGRAM ANNEXED HERETO AS 'ANNEXURE A'.

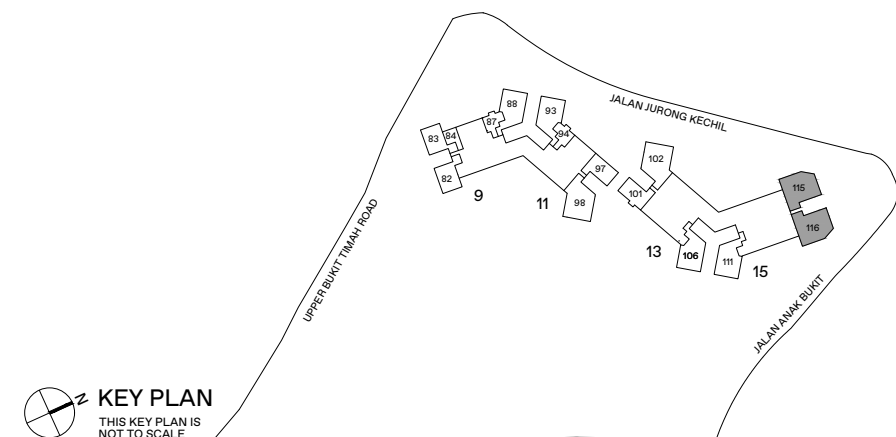

4 - BEDROOM . TYPE D3P

162 sqm | 1,744 sqft

15 Jalan Anak Bukit: #04-115 (Mirrored)
#04-116

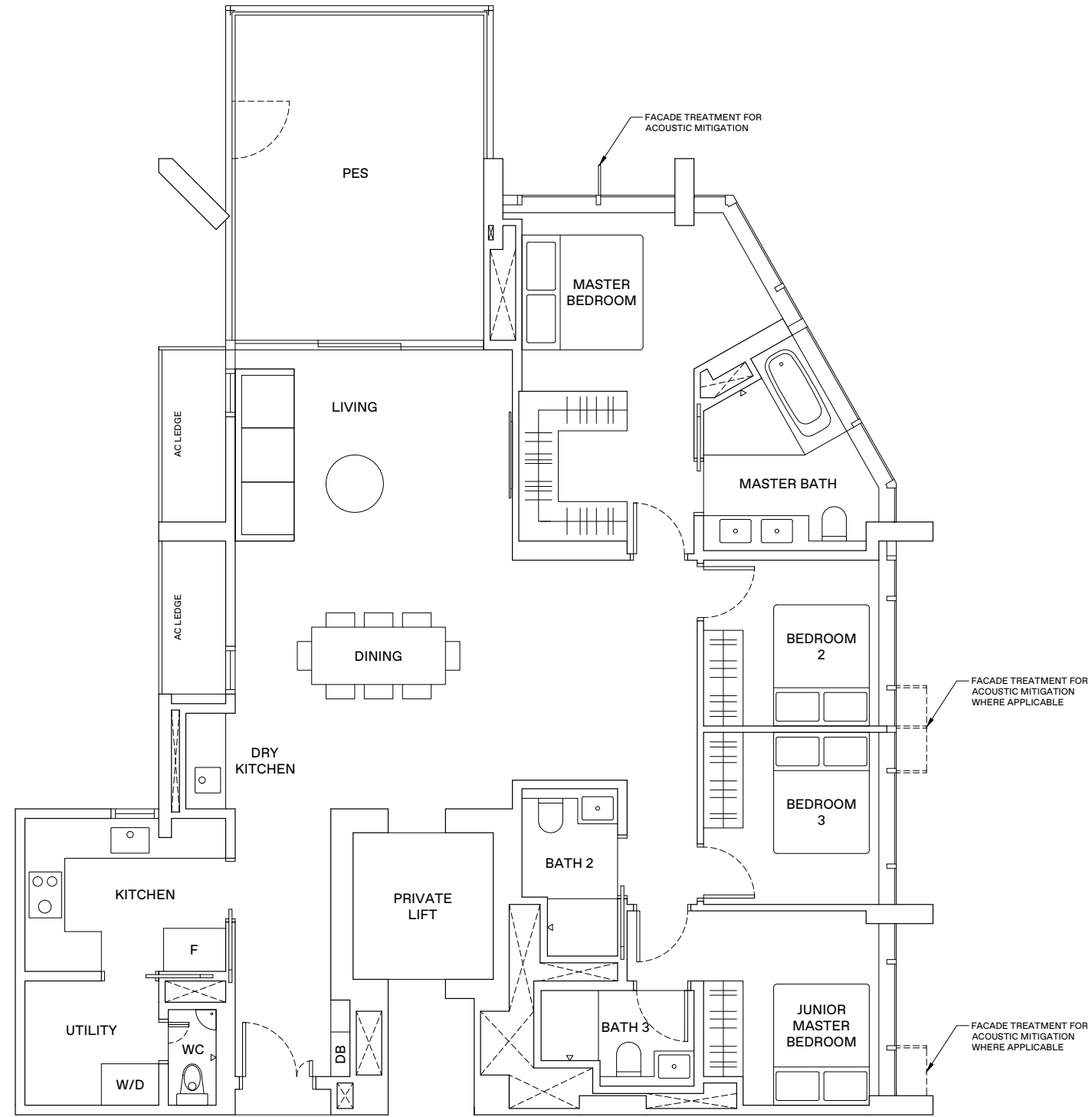

LEGEND

- WD WASHER-DRYER
- W/D WASHER AND DRYER
- F FRIDGE
- DB DISTRIBUTION BOX



AREA INCLUDES AIR-CON (A/C) LEDGE, BALCONY AND STRATA VOID AREA WHERE APPLICABLE. THE PLANS ARE SUBJECT TO CHANGE AS MAY BE APPROVED BY RELEVANT AUTHORITIES. ALL FLOOR PLANS ARE APPROXIMATE MEASUREMENTS ONLY AND ARE SUBJECT TO GOVERNMENT RE-SURVEY. THE BALCONY SHALL NOT BE ENCLOSED UNLESS WITH THE APPROVED BALCONY SCREEN. FOR AN ILLUSTRATION OF THE APPROVED BALCONY SCREEN, PLEASE REFER TO THE DIAGRAM ANNEXED HERETO AS 'ANNEXURE A'.

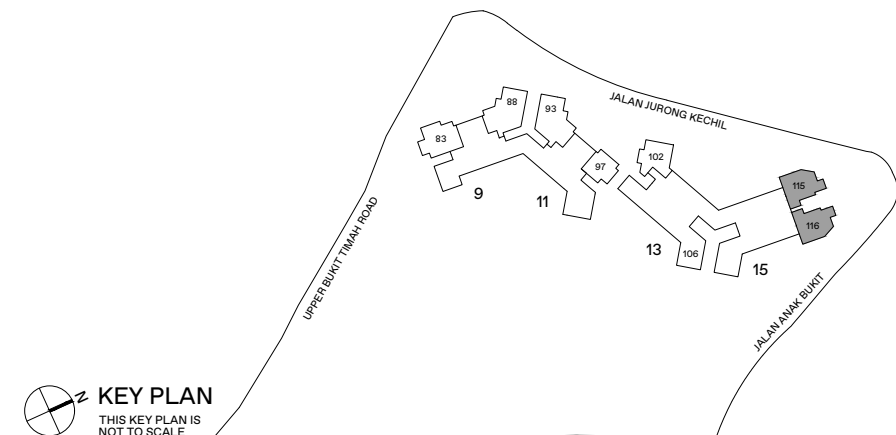

KEY PLAN
THIS KEY PLAN IS NOT TO SCALE

4 - BEDROOM . TYPE D4

151 sqm | 1,625 sqft

15 Jalan Anak Bukit: #06-115 to #16-115, #18-115 to #31-115 (Mirrored)
#06-116 to #16-116, #18-116 to #31-116

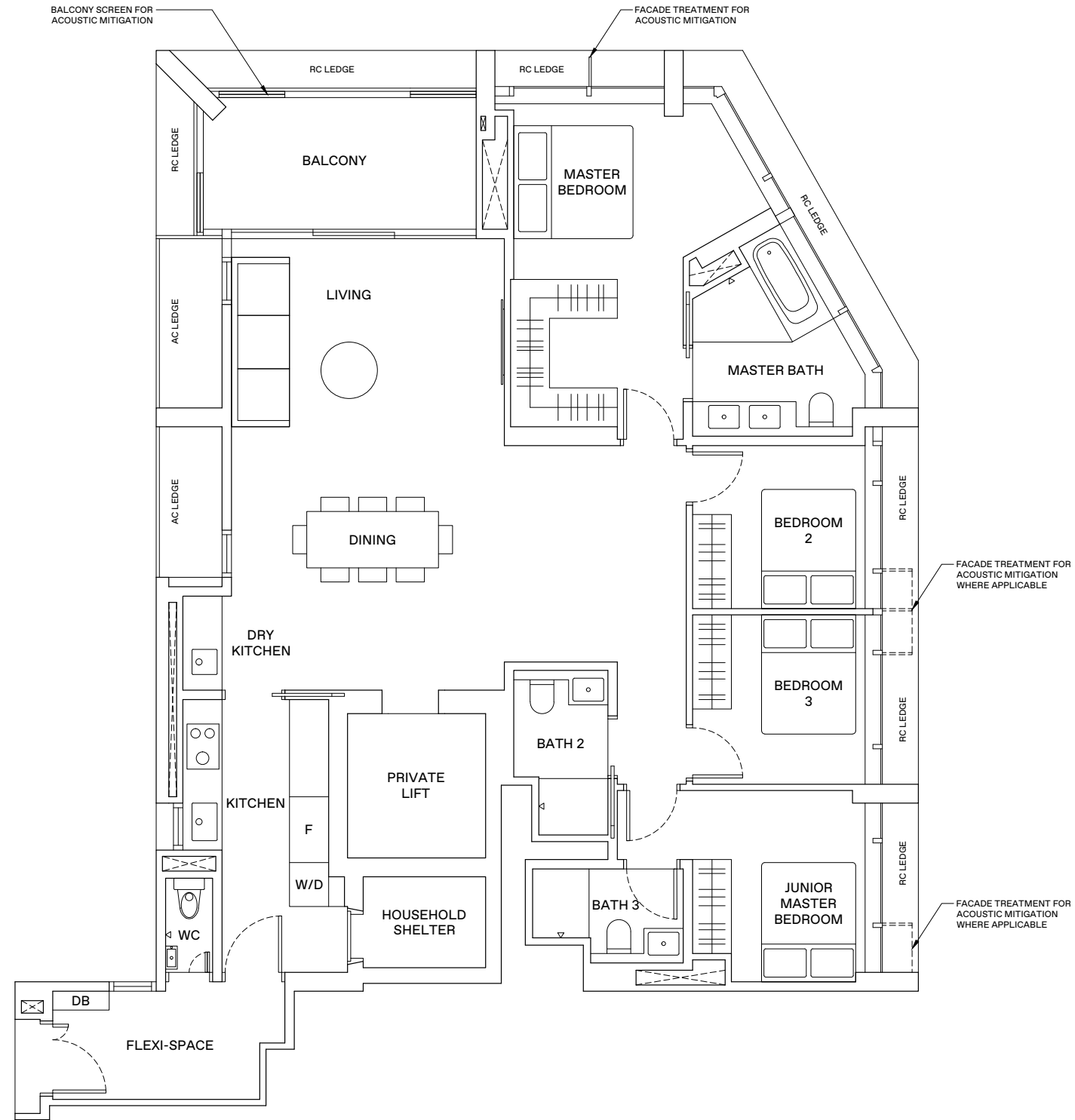

LEGEND

WD	WASHER-DRYER
W/D	WASHER AND DRYER
F	FRIDGE
DB	DISTRIBUTION BOX



AREA INCLUDES AIR-CON (A/C) LEDGE, BALCONY AND STRATA VOID AREA WHERE APPLICABLE. THE PLANS ARE SUBJECT TO CHANGE AS MAY BE APPROVED BY RELEVANT AUTHORITIES. ALL FLOOR PLANS ARE APPROXIMATE MEASUREMENTS ONLY AND ARE SUBJECT TO GOVERNMENT RE-SURVEY. THE BALCONY SHALL NOT BE ENCLOSED UNLESS WITH THE APPROVED BALCONY SCREEN. FOR AN ILLUSTRATION OF THE APPROVED BALCONY SCREEN, PLEASE REFER TO THE DIAGRAM ANNEXED HERETO AS 'ANNEXURE A'.

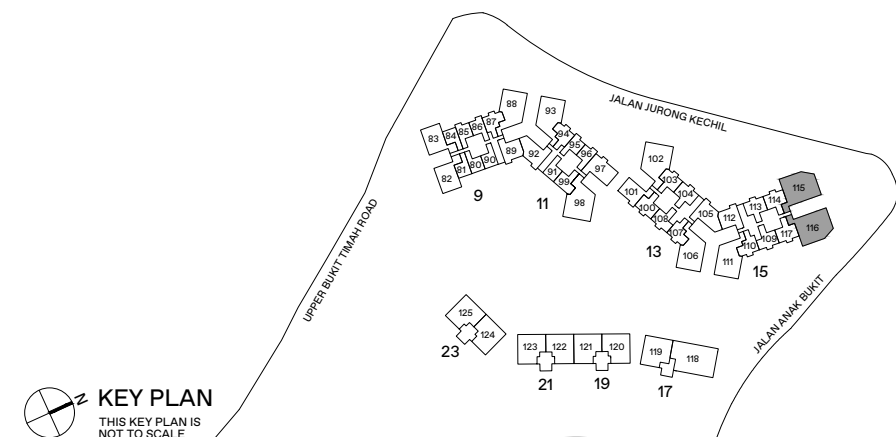

ANNEXURE A

BALCONY SCREEN

APPLICABLE FOR TYPE A2 / B2* / B3* / B4 / B4A / B5 / B5A* / B7 / B7A / B8 / B9P / B9 / C2 / C2A / C3 / P3*

Notes:

1. The balcony shall not be enclosed unless with the approved balcony screen.
2. The purchasers shall have to bear the costs of installing the balcony screen except for the units mentioned in Note 3.
3. The balcony screen will be provided in the following units:
 (1) #18-100 - #31-100, (2) #18-101 - #31-101, (3) #18-107 - #31-107, (4) #18-108 - #31-108,
 (5) #06-109 - #16-109, (6) #06-110 - #16-110, (7) #18-110 - #31-110, (8) #06-117 - #16-117, (9) #18-117 - #31-117

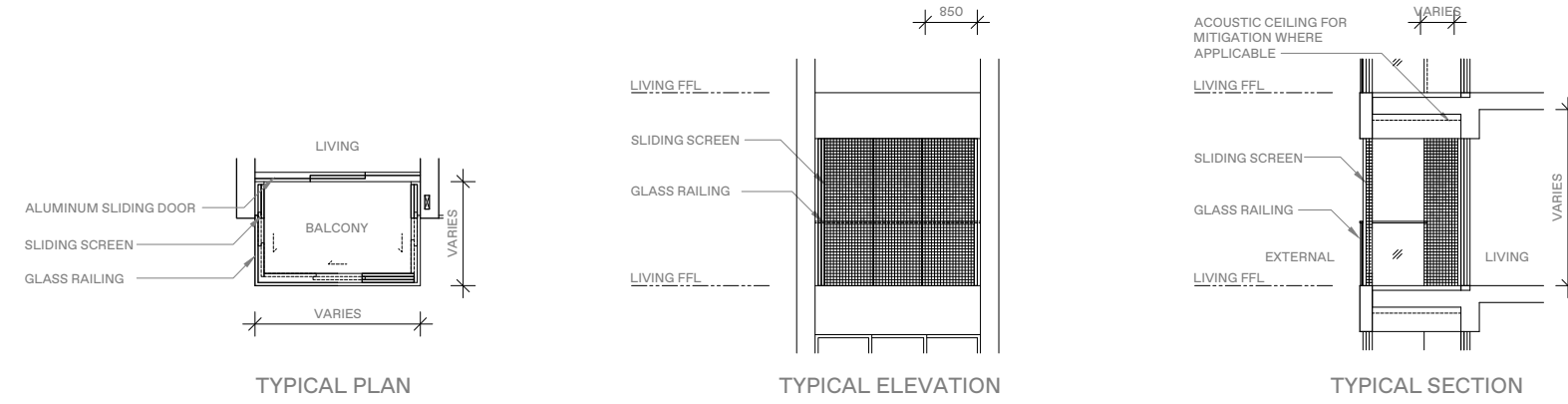

BALCONY SCREEN

APPLICABLE FOR TYPE C6 / C7 / C8

Notes:

1. The balcony shall not be enclosed unless with the approved balcony screen.
2. The purchasers shall have to bear the costs of installing the balcony screen.

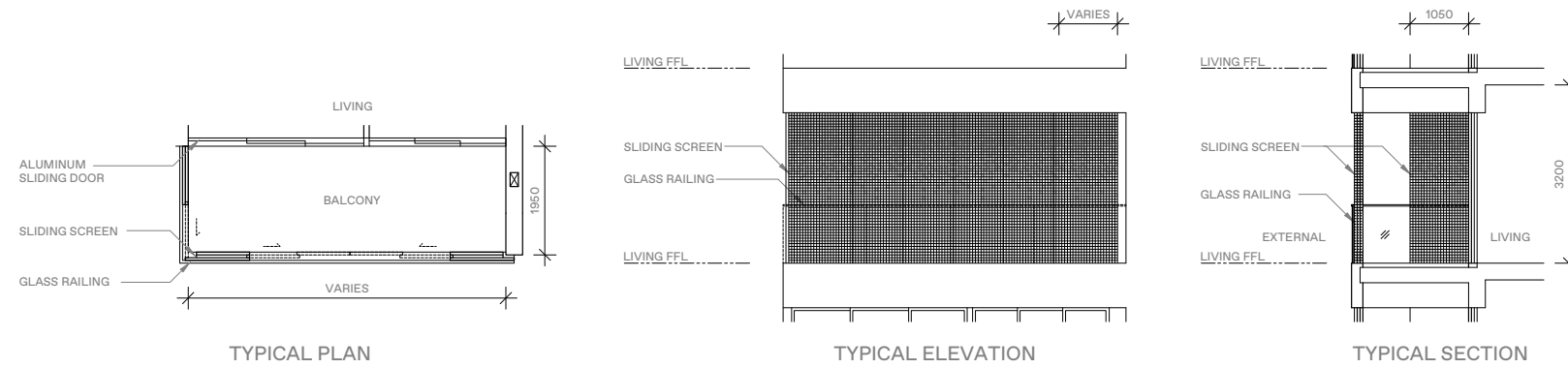

BALCONY SCREEN

APPLICABLE FOR TYPE C4P / C4 / C9* / C10* / D2P / D2 / D3 / D5

Notes:

1. The balcony shall not be enclosed unless with the approved balcony screen.
2. The purchasers shall have to bear the costs of installing the balcony screen except for the units mentioned in Note 3.
3. The balcony screen will be provided in the following units:
 (1) #05-106 - #32-106, (2) #05-111 - #32-111, (3) #05-115 - #32-115, (4) #05-116 - #32-116

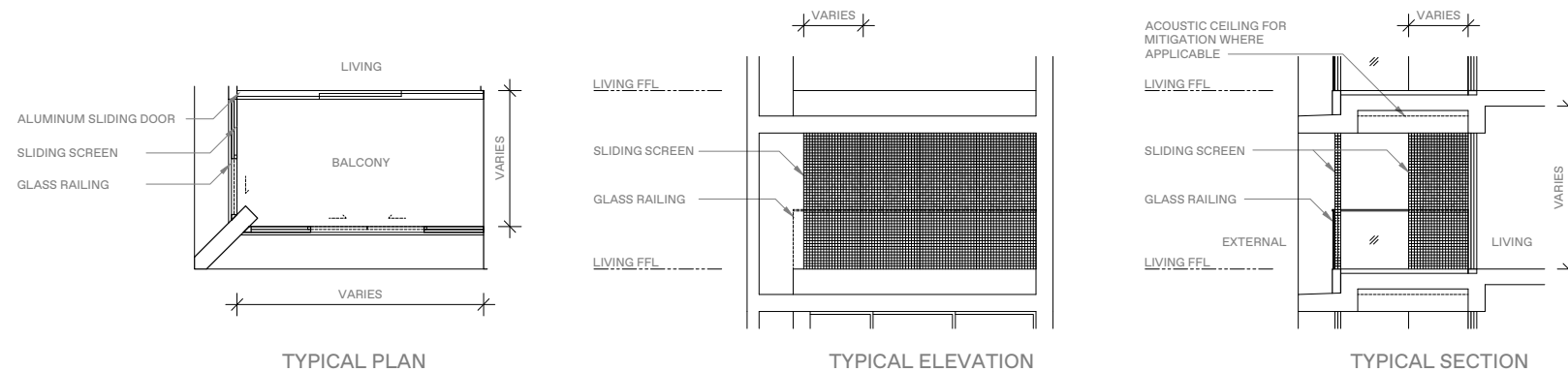

Scan here for
e-brochure



thereserveresidences.com.sg Call 6534 8000 WhatsApp 9712 2344

DISCLAIMER: The information contained herein is subject to change and cannot form part of an offer or contract. While every reasonable care has been taken in providing this information, the developer or its agent cannot be held responsible for any inaccuracies. Whilst we believe the contents of this brochure to be correct and accurate at time of print, they are not to be regarded as statements or representations of fact. Illustrations in the brochure are artist's impressions, which serve only to give an approximate idea of the project. All artist's impressions and all plans are subject to any amendments as may be approved by the relevant authorities. The developer reserves the right to modify any parts of the building prior to project completion as approved or directed by the Planning Authorities or as the owner deems fit in its sole discretion. The developer reserves any and all copyright, design and other proprietary rights in and to this document (or any part thereof) including all or any part of the information, material or artwork contained therein. Unless otherwise expressly agreed to in writing, this document or any part thereof may not be copied, modified, distributed, reproduced or reused without the express written consent of the developer.

Developer: FE Landmark Pte. Ltd., FEC Residences Trustee Pte. Ltd. (in its capacity as Trustee-Manager of FEC Residences Trust) & FEC Retail Trustee Pte. Ltd. (in its capacity as Trustee-Manager of FEC Retail Trust) • Licence No.: C1463 • Tenure: 99 years commencing from 29 Nov 2021 • Encumbrances: (i) Caveat IH/21880E in favour of DBS Bank Ltd. (ii) Mortgage executed in escrow in favour of DBS Bank Ltd. • Land Description: Lot No. 2843M & 2852K of MK 16 at Jalan Anak Bukit • Expected Vacant Possession Date: 31 Dec 2028 • Expected Legal Completion Date: 31 Dec 2031

P5000/0508



THE
RESERVE
RESIDENCES

CREEKSIDE

FLOOR PLANS

THE HEART OF BUKIT TIMAH





Welcome to the heart of Bukit Timah, a prestigious and sought-after location that embodies the best of urban living. This prime estate is known for its upscale residences, top-tier schools, and abundance of greenery, offering an unparalleled lifestyle that combines the convenience of modern amenities with the serenity of lush greenery.

SCHEMATIC DIAGRAM

	17 JALAN ANAK BUKIT		19 JALAN ANAK BUKIT		21 JALAN ANAK BUKIT		23 JALAN ANAK BUKIT						
UNIT / FLOOR	118	119		120	121		122	123		124	125		
12	ROOF TERRACE			ROOF TERRACE			ROOF TERRACE			ROOF TERRACE			
11	D1	C7		C6	C8		C6	C8		C6	C8		
10	D1	C7		C6	C8		C6	C8		C6	C8		
9	D1	C7		C6	C8		C6	C8		C6	C8		
8	D1	C7		C6	C8		C6	C8		C6	C8		
7	D1	C7		C6	C8		C6	C8		C6	C8		
6	D1P	C7P	LANDSCAPE	C6P	C8P	LANDSCAPE	C6P	C8P	LANDSCAPE	C6P	C8P	LANDSCAPE	
5	RESIDENTIAL CARPARK						RESIDENTIAL CARPARK						
4	RESIDENTIAL CARPARK						RESIDENTIAL CARPARK						RETAIL
3							BUS INTERCHANGE						RETAIL
2													RETAIL
1	RETAIL CARPARK												RETAIL

CREEKSIDE

 3-Bedroom
Type C6-C8P

 4-Bedroom
Type D1, D1P

All units will be fitted with window restrictor.

UNIT PLAN LEVEL 6-16





- Others**
- A Residential Entrance (Level 3)
 - B Water Tanks (Level 12, 17, 31, 32)
 - C Generator Set (Level 6)
 - D Substation (Level 1)
 - E Bin Centre (Level 1)
 - F Cooling Towers (Level 4)

THE RESERVE RESIDENCES

-  1-Bedroom Type A1, A2
-  2-Bedroom Type B1-B5, B7
-  2-Bedroom + Study Type B9
-  3-Bedroom Type C2, C3, C4

HORIZON

-  3-Bedroom Type C9, C10
-  4-Bedroom Type D2, D4

CREEKSIDE

-  3-Bedroom Type C6-C8P
-  4-Bedroom Type D1, D1P

3-BEDROOM . TYPE C6/C6P
 104 sqm | 1,119 sqft (C6), 124 sqm | 1,335 sqft (C6P)

19 Jalan Anak Bukit: #06-120 (C6P)
 #07-120 to #11-120 (C6)
 21 Jalan Anak Bukit: #06-122 (C6P)
 #07-122 to #11-122 (C6)
 23 Jalan Anak Bukit: #06-124 (C6P)
 #07-124 to #11-124 (C6)

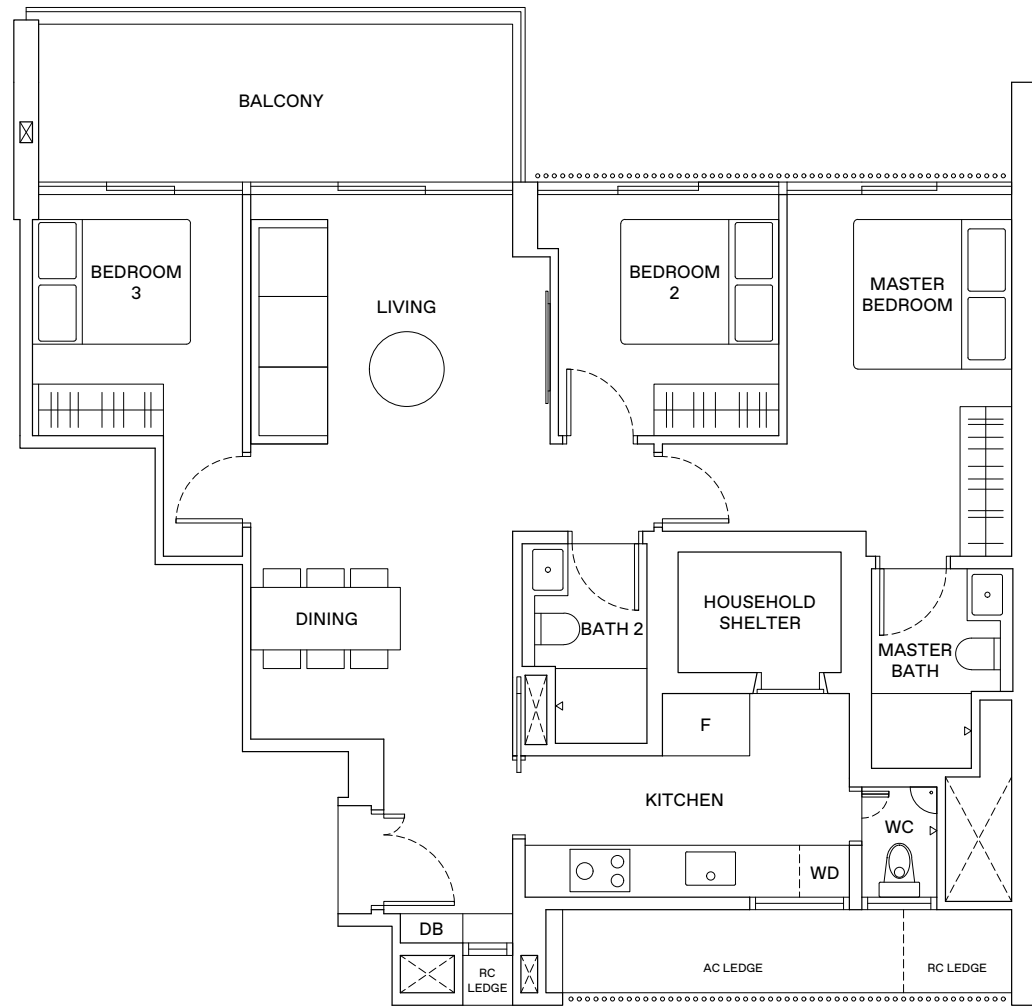
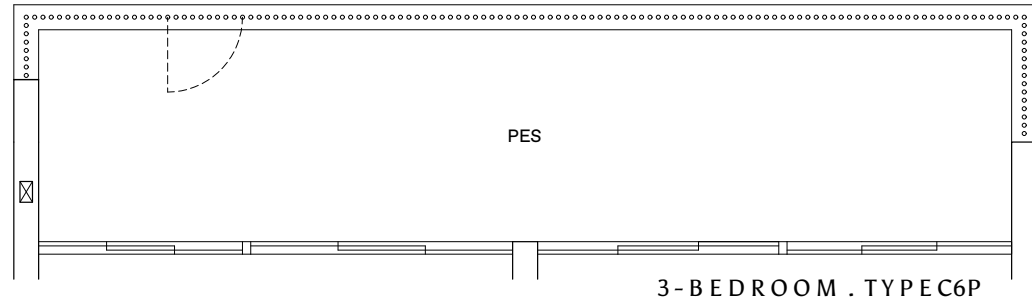

LEGEND

WD WASHER-DRYER
 W/D WASHER AND DRYER
 F FRIDGE
 DB DISTRIBUTION BOX



AREA INCLUDES AIR-CON (A/C) LEDGE, BALCONY AND STRATA VOID AREA WHERE APPLICABLE. THE PLANS ARE SUBJECT TO CHANGE AS MAY BE APPROVED BY RELEVANT AUTHORITIES. ALL FLOOR PLANS ARE APPROXIMATE MEASUREMENTS ONLY AND ARE SUBJECT TO GOVERNMENT RE-SURVEY. THE BALCONY SHALL NOT BE ENCLOSED UNLESS WITH THE APPROVED BALCONY SCREEN. FOR AN ILLUSTRATION OF THE APPROVED BALCONY SCREEN, PLEASE REFER TO THE DIAGRAM ANNEXED HERETO AS "ANNEXURE A".

KEY PLAN
 THIS KEY PLAN IS NOT TO SCALE

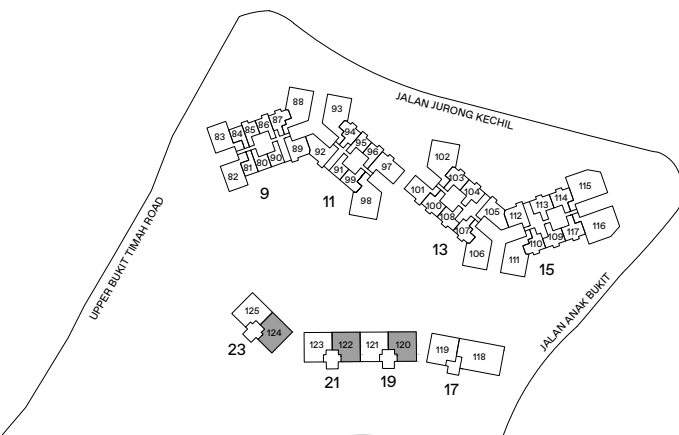

3-BEDROOM . TYPE C7/C7P
 104 sqm | 1,119 sqft (C7), 124 sqm | 1,335 sqft (C7P)

17 Jalan Anak Bukit: #06-119 (C7P)
 #07-119 to #11-119 (C7)

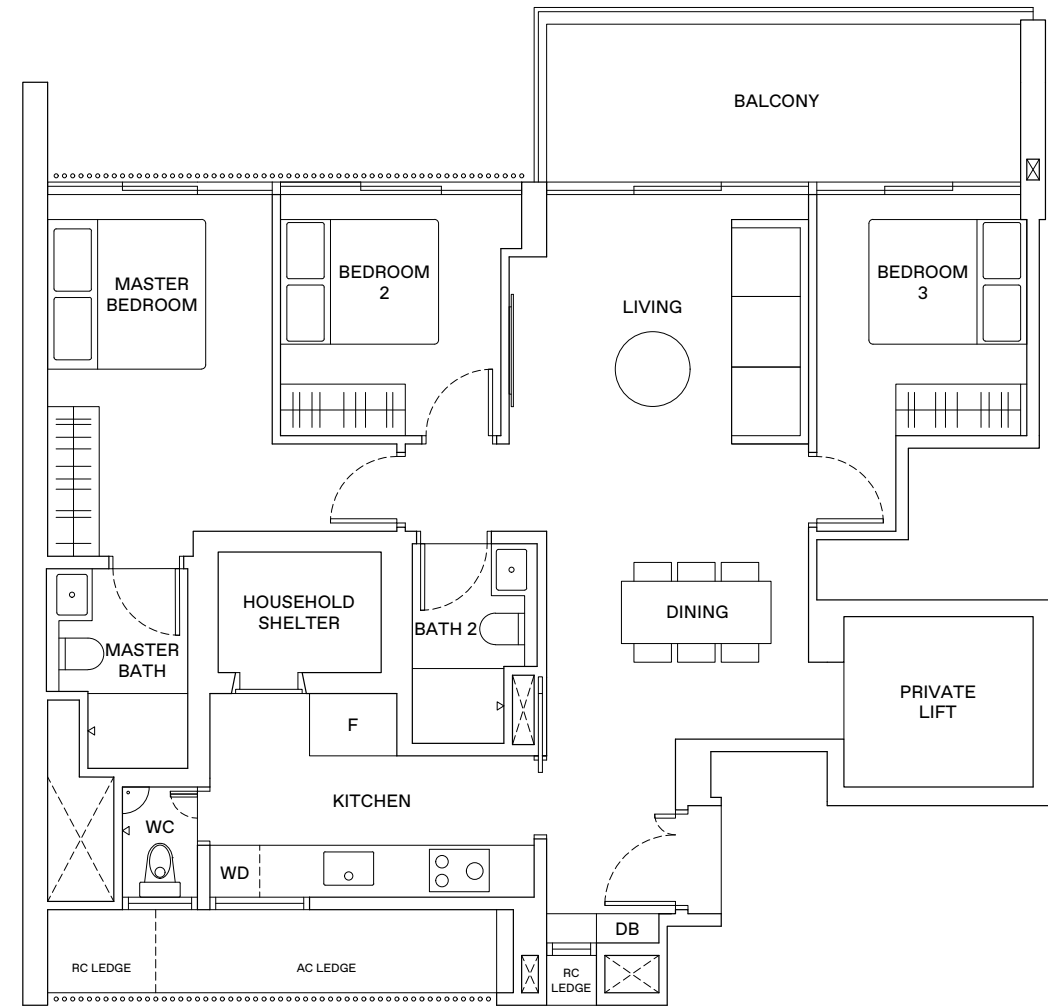
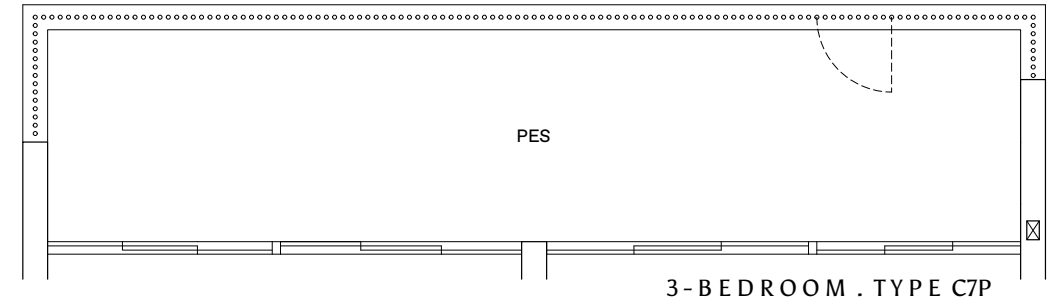

LEGEND

WD WASHER-DRYER
 W/D WASHER AND DRYER
 F FRIDGE
 DB DISTRIBUTION BOX



AREA INCLUDES AIR-CON (A/C) LEDGE, BALCONY AND STRATA VOID AREA WHERE APPLICABLE. THE PLANS ARE SUBJECT TO CHANGE AS MAY BE APPROVED BY RELEVANT AUTHORITIES. ALL FLOOR PLANS ARE APPROXIMATE MEASUREMENTS ONLY AND ARE SUBJECT TO GOVERNMENT RE-SURVEY. THE BALCONY SHALL NOT BE ENCLOSED UNLESS WITH THE APPROVED BALCONY SCREEN. FOR AN ILLUSTRATION OF THE APPROVED BALCONY SCREEN, PLEASE REFER TO THE DIAGRAM ANNEXED HERETO AS "ANNEXURE A".

KEY PLAN
 THIS KEY PLAN IS NOT TO SCALE

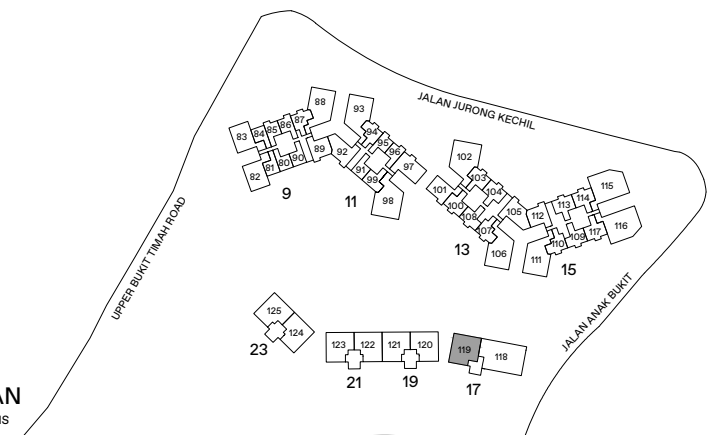

3-BEDROOM . TYPE C8/C8P
 108 sqm | 1,163 sqft (C8), 128 sqm | 1,378 sqft (C8P)

- 19 Jalan Anak Bukit: #06-121 (C8P)
 #07-121 to #11-121 (C8)
- 21 Jalan Anak Bukit: #06-123 (C8P)
 #07-123 to #11-123 (C8)
- 23 Jalan Anak Bukit: #06-125 (C8P)
 #07-125 to #11-125 (C8)

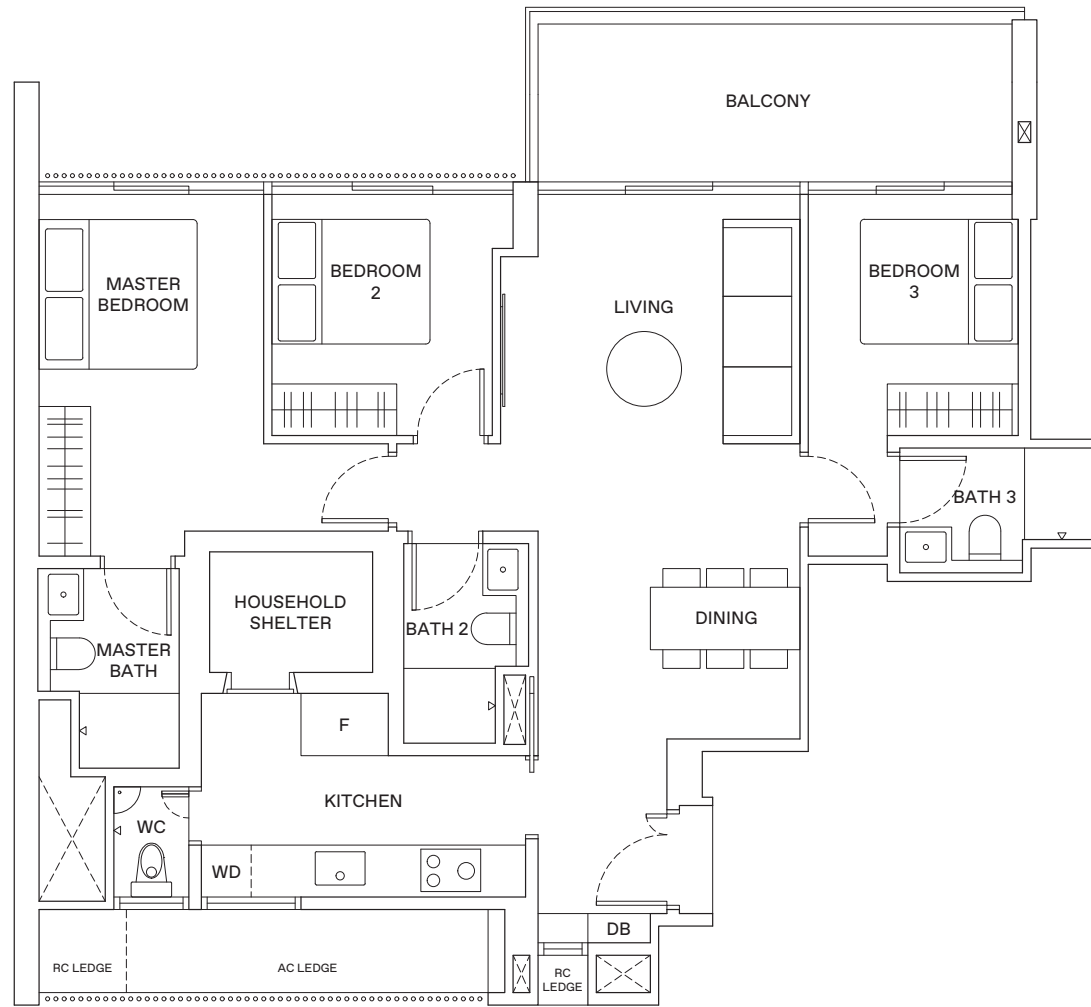
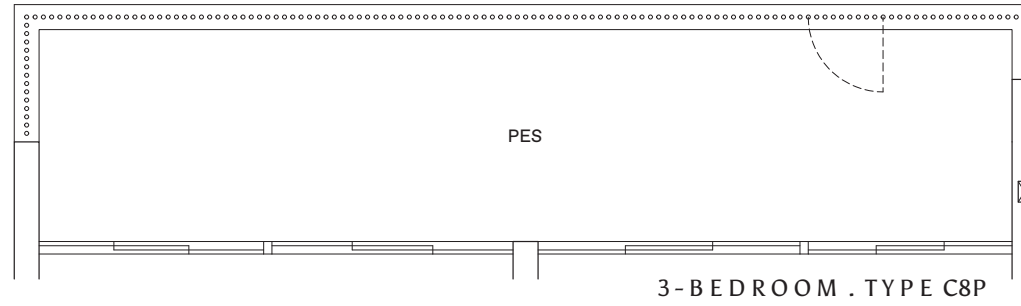

LEGEND

- WD WASHER-DRYER
- W/D WASHER AND DRYER
- F FRIDGE
- DB DISTRIBUTION BOX



AREA INCLUDES AIR-CON (A/C) LEDGE, BALCONY AND STRATA VOID AREA WHERE APPLICABLE. THE PLANS ARE SUBJECT TO CHANGE AS MAY BE APPROVED BY RELEVANT AUTHORITIES. ALL FLOOR PLANS ARE APPROXIMATE MEASUREMENTS ONLY AND ARE SUBJECT TO GOVERNMENT RE-SURVEY. THE BALCONY SHALL NOT BE ENCLOSED UNLESS WITH THE APPROVED BALCONY SCREEN. FOR AN ILLUSTRATION OF THE APPROVED BALCONY SCREEN, PLEASE REFER TO THE DIAGRAM ANNEXED HERETO AS 'ANNEXURE A'.

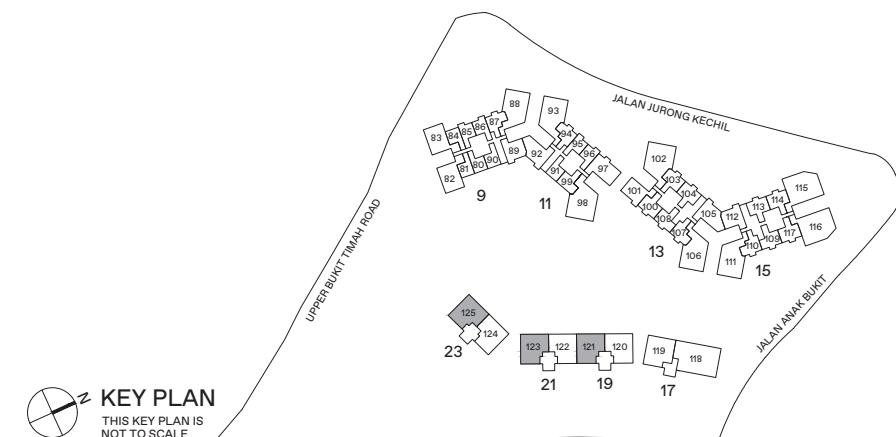

4 - BEDROOM . TYPE D1/D1P
 176 sqm | 1,894 sqft (D1), 203 sqm | 2,185 sqft (D1P)

17 Jalan Anak Bukit: #06-118 (D1P), #07-118 to #11-118 (D1)

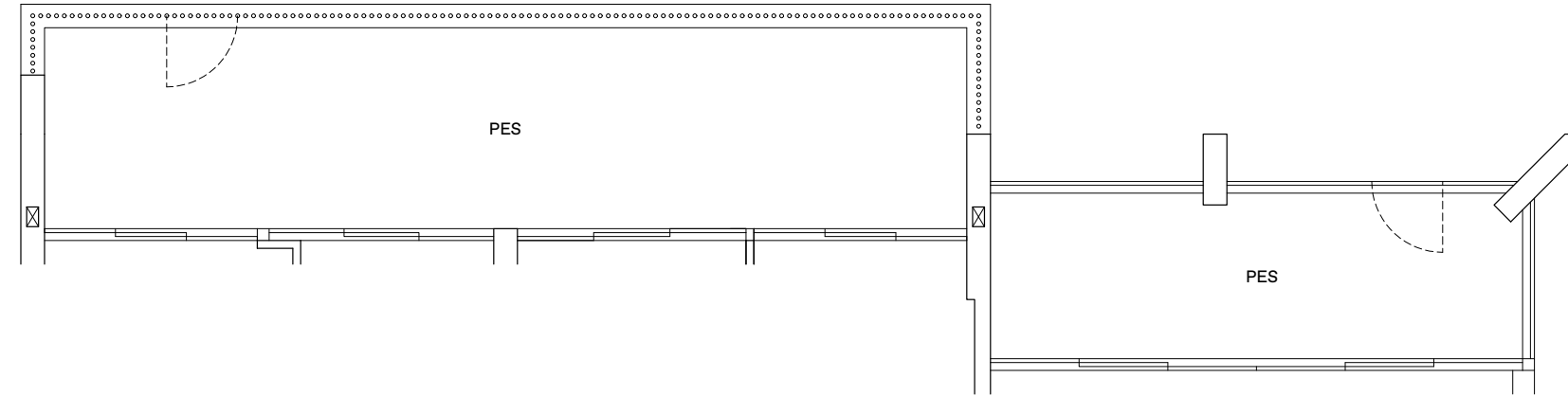

4-BEDROOM . TYPE DIP

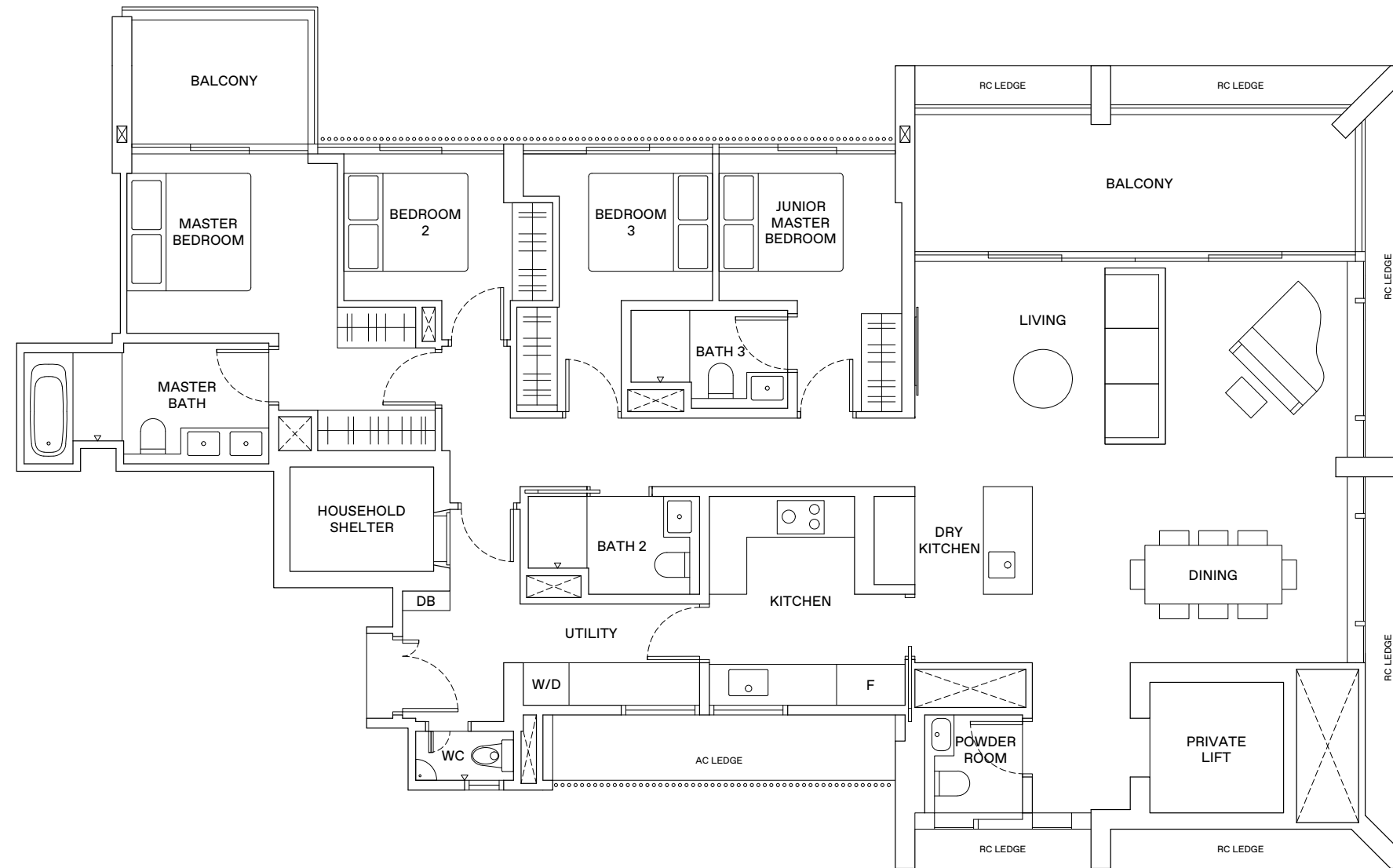

LEGEND

- WD WASHER-DRYER
- W/D WASHER AND DRYER
- F FRIDGE
- DB DISTRIBUTION BOX



AREA INCLUDES AIR-CON (A/C) LEDGE, BALCONY AND STRATA VOID AREA WHERE APPLICABLE. THE PLANS ARE SUBJECT TO CHANGE AS MAY BE APPROVED BY RELEVANT AUTHORITIES. ALL FLOOR PLANS ARE APPROXIMATE MEASUREMENTS ONLY AND ARE SUBJECT TO GOVERNMENT RE-SURVEY. THE BALCONY SHALL NOT BE ENCLOSED UNLESS WITH THE APPROVED BALCONY SCREEN. FOR AN ILLUSTRATION OF THE APPROVED BALCONY SCREEN, PLEASE REFER TO THE DIAGRAM ANNEXED HERETO AS 'ANNEXURE A'.

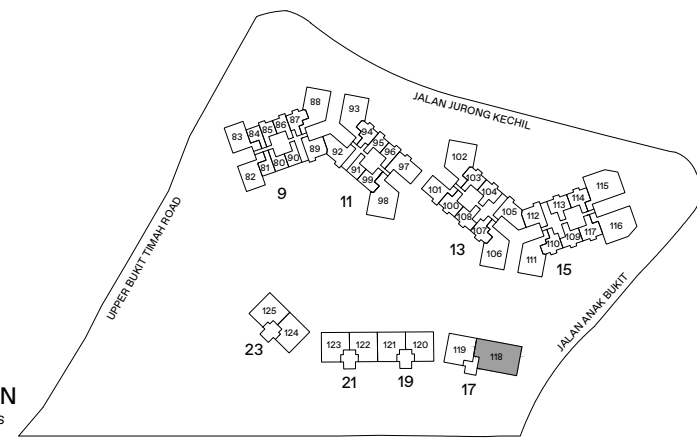

ANNEXURE A

BALCONY SCREEN

APPLICABLE FOR TYPE A2 / B2* / B3* / B4 / B4A / B5 / B5A* / B7 / B7A / B8 / B9P / B9 / C2 / C2A / C3 / P3*

Notes:

1. The balcony shall not be enclosed unless with the approved balcony screen.
2. The purchasers shall have to bear the costs of installing the balcony screen except for the units mentioned in Note 3.
3. The balcony screen will be provided in the following units:
 (1) #18-100 - #31-100, (2) #18-101 - #31-101, (3) #18-107 - #31-107, (4) #18-108 - #31-108,
 (5) #06-109 - #16-109, (6) #06-110 - #16-110, (7) #18-110 - #31-110, (8) #06-117 - #16-117, (9) #18-117 - #31-117

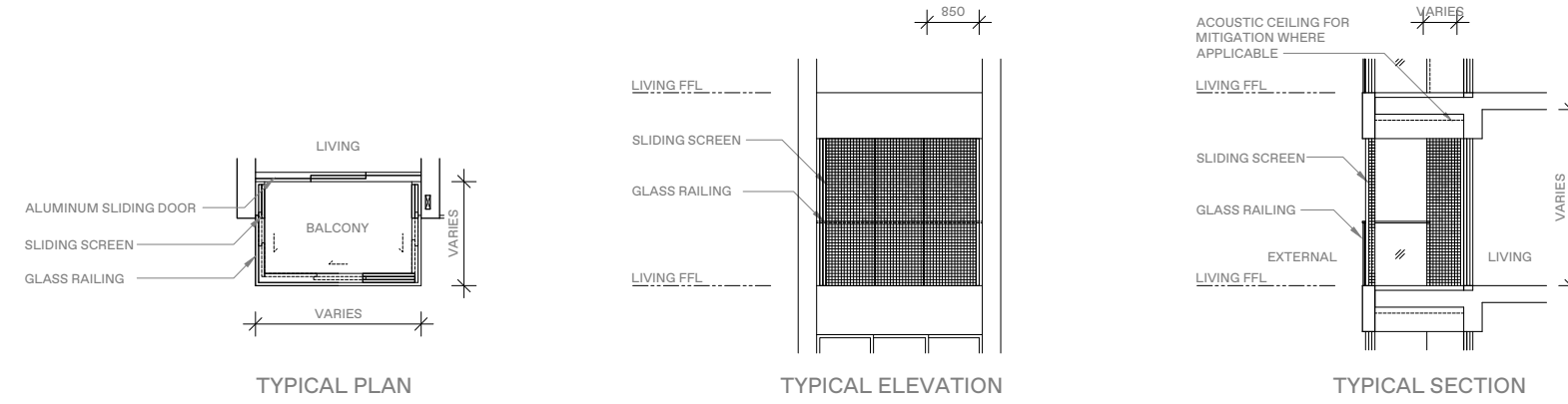

BALCONY SCREEN

APPLICABLE FOR TYPE C6 / C7 / C8

Notes:

1. The balcony shall not be enclosed unless with the approved balcony screen.
2. The purchasers shall have to bear the costs of installing the balcony screen.

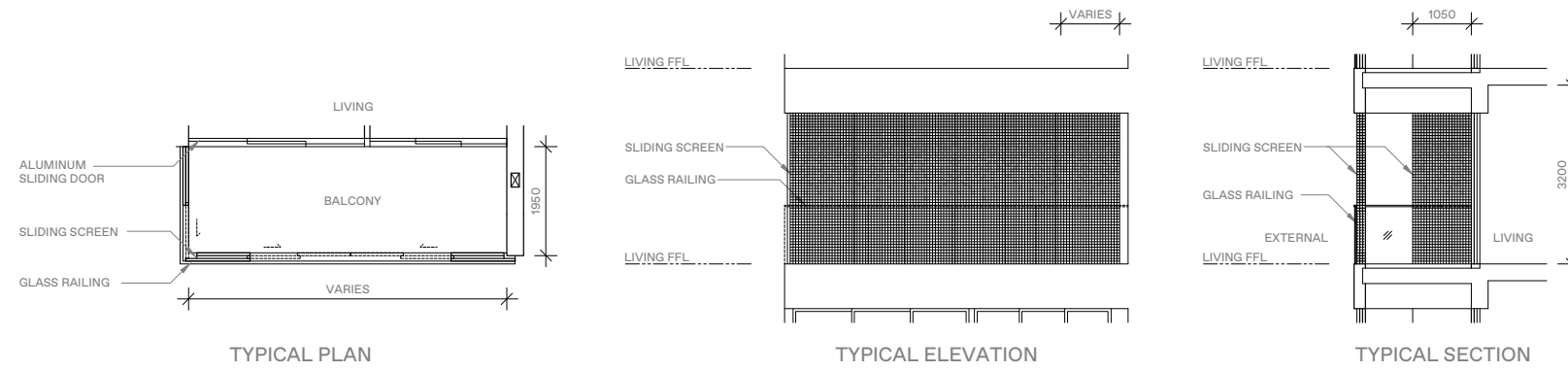

BALCONY SCREEN

APPLICABLE FOR TYPE C4P / C4 / C9* / C10* / D2P / D2 / D3 / D5

Notes:

1. The balcony shall not be enclosed unless with the approved balcony screen.
2. The purchasers shall have to bear the costs of installing the balcony screen except for the units mentioned in Note 3.
3. The balcony screen will be provided in the following units:
 (1) #05-106 - #32-106, (2) #05-111 - #32-111, (3) #05-115 - #32-115, (4) #05-116 - #32-116

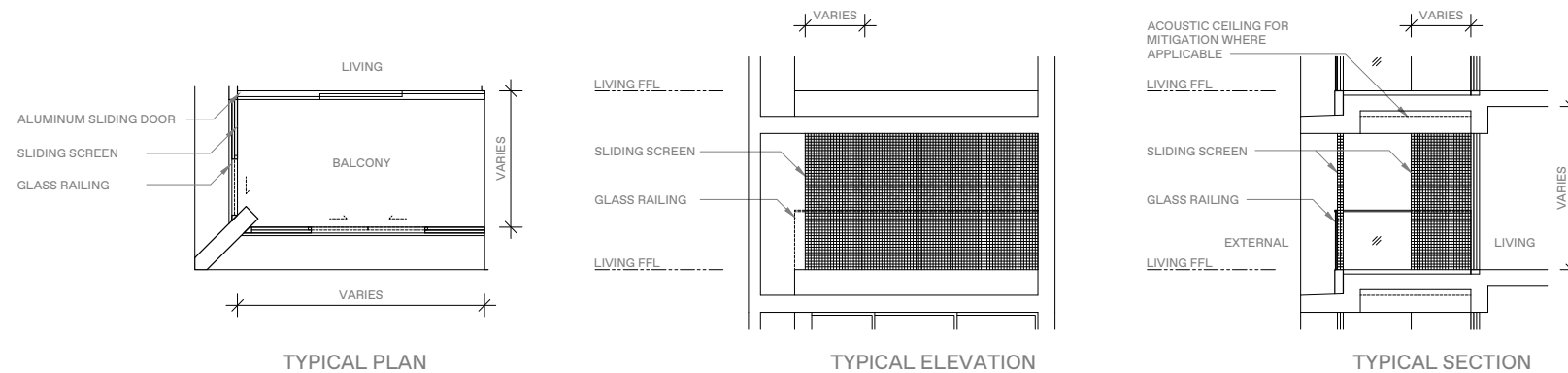

Scan here for
e-brochure



thereserveresidences.com.sg Call 6534 8000 WhatsApp 9712 2344

DISCLAIMER: The information contained herein is subject to change and cannot form part of an offer or contract. While every reasonable care has been taken in providing this information, the developer or its agent cannot be held responsible for any inaccuracies. Whilst we believe the contents of this brochure to be correct and accurate at time of print, they are not to be regarded as statements or representations of fact. Illustrations in the brochure are artist's impressions, which serve only to give an approximate idea of the project. All artist's impressions and all plans are subject to any amendments as may be approved by the relevant authorities. The developer reserves the right to modify any parts of the building prior to project completion as approved or directed by the Planning Authorities or as the owner deems fit in its sole discretion. The developer reserves any and all copyright, design and other proprietary rights in and to this document (or any part thereof) including all or any part of the information, material or artwork contained therein. Unless otherwise expressly agreed to in writing, this document or any part thereof may not be copied, modified, distributed, reproduced or reused without the express written consent of the developer.

Developer: FE Landmark Pte. Ltd., FEC Residences Trustee Pte. Ltd. (in its capacity as Trustee-Manager of FEC Residences Trust) & FEC Retail Trustee Pte. Ltd. (in its capacity as Trustee-Manager of FEC Retail Trust) • Licence No.: C1463 • Tenure: 99 years commencing from 29 Nov 2021 • Encumbrances: (i) Caveat IH/21880E in favour of DBS Bank Ltd. (ii) Mortgage executed in escrow in favour of DBS Bank Ltd. • Land Description: Lot No. 2843M & 2852K of MK 16 at Jalan Anak Bukit • Expected Vacant Possession Date: 31 Dec 2028 • Expected Legal Completion Date: 31 Dec 2031

P1000/0508